

# CARVER MARINER

MODEL 3396

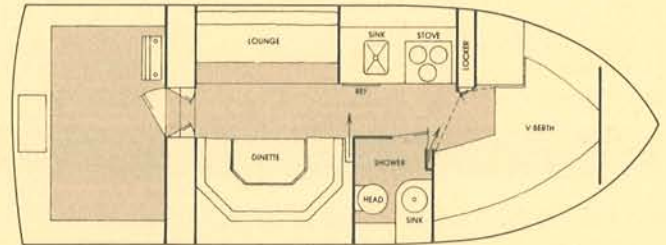
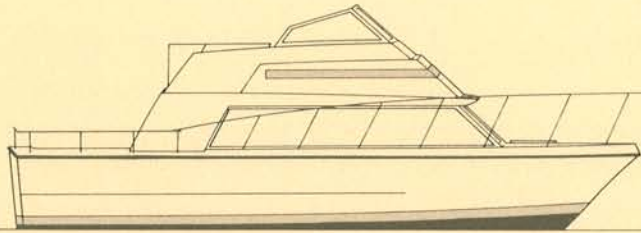

## PROFILE

<b>LENGTH</b> (center line) .....	32'9"	9.98m
<b>BEAM</b> .....	12'0"	3.66m
<b>WEIGHT</b> .....	11,620 lb.	5,269kg
<b>HEIGHT</b> (above water) .....	11'5"	3.48m
<b>CABIN HEAD ROOM</b> .....	77"	1.96m

### PROPULSION SYSTEM

#### ENGINES/REDUCTIONS

Twin inboards to 540 hp with 2:05:1 reductions/direct couple V-drive

<b>SHAFTS</b>	1-3/8" stainless steel
<b>STRUTS</b>	Bronze
<b>RUDDERS</b>	Bronze — 1-1/4" stainless steel shaft

### FUEL SYSTEM

Standard .....	145 gal.	549L
Optional .....	57 gal.	242L

### WATER SYSTEM

Pressure hot and cold water  
Standard capacity .....

70 gal.	265L
---------	------

### RAILS

Standard: Rails — stainless steel  
Fittings — zamac  
Taffrail — teak  
Optional: Deluxe Rail Fittings — stainless steel

### WINDSHIELD/WINDOWS

Aluminum frames with laminated safety glass

### CLEATS

Stainless steel (includes 4 spring line cleats)

## STANDARD EQUIPMENT

### EXTERIOR

- Anti-fouling hull bottom
- Bow rail and teak taffrail
- Deck hardware: chock, cleats, and chain deck pipe
- Command bridge with teak windshield, ladder, railings and swivel pilot seat
- Foredeck hatch
- Lights, anchor and navigation
- Windshield wiper
- Window screens

### CONTROL CONSOLE

- Fuel gauge
- Lights, instrument
- Oil pressure gauges
- Tachometers
- Voltmeters
- Temperature gauges

### FUNCTIONAL/SAFETY

- Two automatic bilge pumps
- Bilge blower
- Horn, single trumpet
- Mufflers

### ELECTRICAL

- Alternators
- Two batteries
- Dockside wiring with shore cables

### GALLEY

- Refrigerator, 12V/110V combination (DE 728)
- Sink
- Stove (3 burner electric)
- Pressure hot and cold water system/12 gal. heater

### INTERIOR

#### Colors: Blue, Natural

- Dinette (converts to a double berth)
- Sofa (converts to a double berth)
- Carpeting
- Hulliner
- Draperies
- Cushions
- Headliner

### HEAD

- Mirror
- Fiberglass shower stall with shower
- Vanity with stainless steel sink

### MISCELLANEOUS

- Shipping Cradle

## OPTIONAL EQUIPMENT

- Vinyl convertible top set
- Side curtain screens
- Self-contained head
- Lectra San
- Self contained head with auxiliary holding tank
- Spotlight, manual control
- Electric control spotlight, single station
- Generator
- Fresh water cooling — generator
- Propane stove with oven
- Cassette stereo with AM/FM radio
- 57 gallon auxiliary fuel tank
- Teak boarding ladder
- Fiberglass swim platform with ladder
- Deluxe saltwater hardware set
- Air conditioning with reverse heat
- Double trumpet horn
- Electric windshield wiper, passenger side
- Electric cigar lighter
- Engine hour meter
- Compass
- Fresh water cooling for engines
- Engine heat exchanger for hot water system
- 30 amp grounded household adaptor(s)
- Rear deck fiberglass storage/bait wells
- Battery charger system
- Pompanette swivel pilot seat (in lieu of standard)
- 110V blender built into galley top

## ENGINE OPTIONS

- Twin 270 hp Crusader V-drives (2.05:1 reduction)
- Twin 351-4 Pleasurecraft V-drives (2.05:1 reduction)

## PERFORMANCE DATA

### Model: 3396 Mariner

Power . . . . . Twin 225 Pleasurecraft V-Drives  
 Gear Reduction . . . . . 2.05:1  
 Fuel Load . . . . . 55 gal.  
 Water Load . . . . . 75 gal.  
 Passenger Weight . . . . . 310 lb.  
 Test Date . . . . . 8/24/76

Propeller(s) . . . . . 18 x 19 Michigan Quadra jets  
 ETR# . . . . . 3982476  
 Wind . . . . . N-E  
 Temperature . . . . . 85 °F  
 Course . . . . . N-S 1'-2' chop  
 Altitude . . . . . 590 ft. above sea level

**Other Information:** Boat fully equipped including 7.5 KW Kohler generator, air conditioning, aux. fuel tank, 40 gal. holding tank.

RPM	Trim Angle	Timed Speed (MPH)	Fuel Consumption (GPH)
1000	—	—	—
1500	1.0°	7.2	5.0
2000	2.5°	8.9	7.0
2500	4.0°	10.3	9.0
3000	6.5°	15.3	14.0
3500	6.0°	20.8	18.0
4000	3.0°	27.3	24.0
4600	3.0°	31.5	37.0
3500*	4.0°	23.0	17.0

\*Trim planes down

**Recommended Cruising Speed:** 1400-1800 rpm low speed cruise — planes up  
 3000-3300 rpm cruising speed — planes down as needed

The results above were experienced by the specific unit tested. Different boats, engines or test conditions could result in varied performance.

# CARVER

## The Classic American Adventure

Carver Boat Corporation \* Pulaski, Wisconsin 54162 \* Telephone (414) 822-3214