

CARVER VOYAGER

MODEL 3326

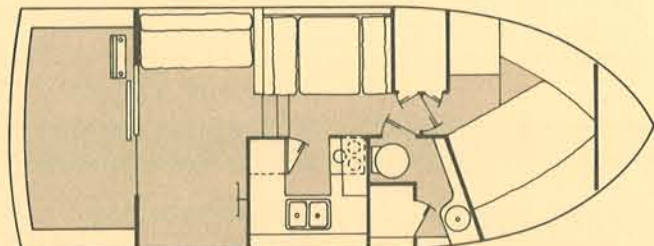
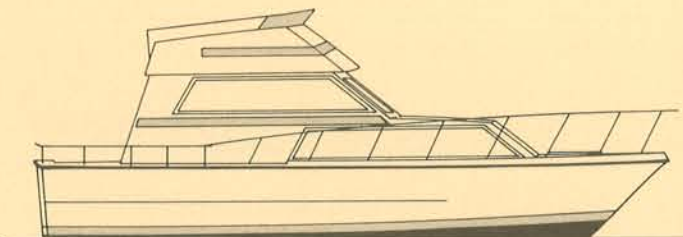

PROFILE

LENGTH (center line)	32'9"	9.98m
BEAM	12'0"	3.66m
WEIGHT	12,600 lb.	5,714kg
HEIGHT (above water)	11'9"	3.58m
CABIN HEAD ROOM	75"	1.90m

PROPULSION SYSTEM

ENGINES/REDUCTIONS

Twin inboards to 540 hp with 2.05:1 reductions/direct couple V-drive

SHAFTS	1-3/8" stainless steel
STRUTS	Bronze
RUDDERS	Bronze — 1-1/4" stainless steel shaft

FUEL SYSTEM

Standard	200 gal.	757L
Optional	N/A	

WATER SYSTEM

Pressure hot and cold water	
Standard capacity	70 gal. 265L

RAILS

Standard:	Rails — stainless steel
	Fittings — zamac
	Taffrail — teak
Optional:	Deluxe Rail Fittings — stainless steel

WINDSHIELD/WINDOWS

Aluminum frames with laminated safety glass

CLEATS

Stainless steel (includes 4 spring line cleats)

STANDARD EQUIPMENT

EXTERIOR

- Anti-fouling hull bottom
- Bow rail and teak taffrail with gates
- Deck hardware: chocks, cleats, and chain pipe
- Command bridge, with venturi windshield, swivel pilot seat, ladder and railing
- Foredeck hatch
- Lights, anchor and navigation
- Teak trim
- Window screens
- Deluxe saltwater hardware

CONTROL CONSOLE

- Fuel gauge
- Lights, instrument
- Oil pressure gauges
- Tachometer
- Voltmeters
- Temperature gauges

FUNCTIONAL/SAFETY

- Two automatic bilge pumps
- Bilge blower
- Horn, single trumpet
- Trim tabs
- Mufflers

ELECTRICAL

- Alternators
- Two batteries with safety switch
- Dockside wiring with shore cable(s)

GALLEY

- Refrigerator, 12V/110V combination (DE728)
- Sink
- Stove, 3 burner electric
- Pressure hot and cold water system/12 gal. heater

INTERIOR/WHEELHOUSE

Colors: Blue, Natural

- Dinette (converts to double berth)
- Sofa (converts to double berth)
- Carpeting
- Hulliner
- Drapes
- Cushions
- Headliner
- Sliding glass doors to aft deck and screen

HEAD

- Mirror
- Fiberglass shower stall with shower
- Vanity with stainless steel sink

MISCELLANEOUS

- Shipping cradle

OPTIONAL EQUIPMENT

- Lower helm and console with wipers
- Bimini top
- Command bridge cover
- Self contained head
- Lectra San head
- Head with holding tank
- Manual spotlight
- Electric controlled spotlight (dual or single station)
- Generator
- Fresh water cooling for generator
- Propane stove with oven
- Air conditioning with reverse heat
- Cassette stereo
- Teak boarding ladder
- Fiberglass swim platform with ladder
- Deluxe saltwater hardware set
- Double trumpet electric horn
- Engine hour meters
- Compass
- Fire extinguisher
- Fresh water cooling for engines
- Engine heat exchanger
- 30 amp grounded household adaptor(s)
- Battery charger system
- Pompanette swivel pilot seat (in lieu of standard)
- 110V blender built into galley top
- Aft deck lounge

ENGINE OPTIONS

- Twin 270 hp Crusader V-drives (2.05:1 reduction)
- Twin 351-4 Pleasurecraft V-drives (2.05:1 reduction)

PERFORMANCE DATA

Model: 3326 Voyager

<p>Power Twin 270 Crusader V-Drives</p> <p>Gear Reduction 2.05:1</p> <p>Fuel Load 200 gal.</p> <p>Water Load 70 gal.</p> <p>Passenger Weight 360 lb.</p> <p>Test Date 4/26/78</p>	<p>Propeller(s) 18 x 19 Michigan Dyna Quads</p> <p>ETR# 3242678</p> <p>Wind N 0-5 MPH</p> <p>Temperature 68 °F</p> <p>Course N-S</p> <p>Altitude 590 ft. above sea level</p>
---	--

RPM	Trim Angle	Radar Speed (MPH)	Fuel Consumption (GPH)
1000	.5°	4.4	1.0
1500	1.0°	7.2	3.0
2000	2.25°	8.8	6.0
2500	5.25°	11.3	14.0
3000	5.75°	18.4	23.0
3500	4.25°	26.4	27.5
4000	4.0°	28.3	31.0
4350	4.0°	30.0	33.0

Recommended Cruising Speed: 1200-1500 rpm low speed cruise
3100-3400 rpm high speed cruise

The results above were experienced by the specific unit tested. Different boats, engines or test conditions could result in varied performance.

CARVER

The Classic American Adventure

Carver Boat Corporation * Pulaski, Wisconsin 54162 * Telephone (414) 822-3214