

CARVER MONTEREY

MODEL 2687

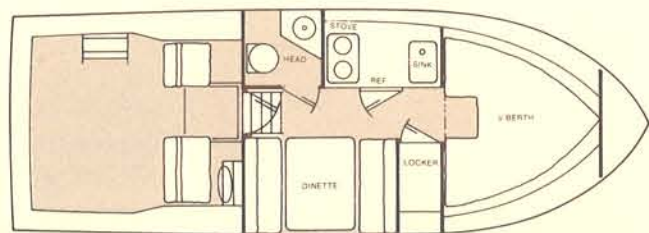
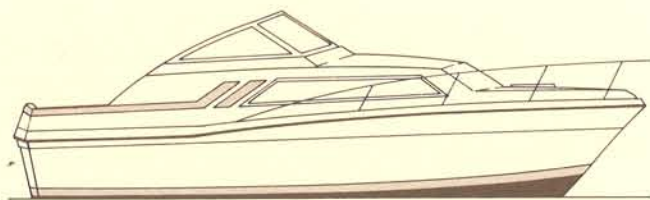

PROFILE

LENGTH (Overall)	25'8"	7.80m
BEAM	8'0"	2.44m
DRAFT	34"	
HEIGHT (Clearance above water)	8'9"	2.67m
DISPLACEMENT	5,250 lb.	2,381kg
CABIN HEADROOM	74"	1.88m
SLEEPING CAPACITY	Standard 4 Optional 5	

FUEL SYSTEM

Capacity	Stern Drive 100 gal.	379L
	V-Drive Inboard 114 gal.	432L

WATER SYSTEM

Manual cold water	40 gal.	152L
Optional hot water system	56 gal.	174L

STANDARD EQUIPMENT

EXTERIOR

- Anti-fouling bottom paint
- Bow rail
- Teak taffrail
- Deck hardware: mooring bitt and two stern cleats
- Spring line cleats, 2
- Fore deck hatch with screen
- Lights, anchor and navigation
- Helm and companion seats, slide and swivel

CONTROL CONSOLE

- Fuel gauge
- Instrument lights
- Oil pressure gauge
- Tachometer
- Voltmeter
- Temperature gauge

FUNCTIONAL/SAFETY

- Automatic electric bilge pump
- Bilge blower
- Horn, single trumpet
- Windshield wiper, electric (helm)
- Anti-skid deck
- Fiberglass inner liner
- Self-bailing cockpit

ELECTRICAL

- Alternator
- Battery with selector switch
- Cabin lighting, 12 VDC

GALLEY

- Ice box
- Sink, stainless steel
- Recessed alcohol stove
- Water system, manual

INTERIOR

Colors: Blue or Natural

- Carpeting
- Cushions
- Drapes
- Hull liner
- Dinette (converts to double berth)
- Hanging locker
- V-berth filler cushion
- Tinted side windows
- Window screens

HEAD

- Water system, manual
- Mirror
- Vanity with stainless steel sink

OPTIONAL EQUIPMENT

- Fresh water cooling (MerCruiser and Crusader)
- Engine alarm, audible (MerCruiser and Crusader)
- Engine hour meter
- Electric/hydraulic trim tabs
- Dual trumpet electric horn
- Compass, illuminated
- Electric cigar lighter with light
- Spotlight, electric remote control
- Additional battery
- Hard top
- Hard top with side and aft curtain
- Vinyl convertible top set
- Aft deck lounge
- Pressure cold water system
- Hot and cold pressure water system with shower
- Engine heat exchanger for hot water system
- Cockpit pressure seawater washdown
- 110V 30 Amp dockside wiring with 50' shore power cable
- Dockside adaptor, 30 Amp
- Voltmeter/ammeter for 110V dockside wiring
- Self-contained head
- Decorator pillows
- Cassette stereo with AM/FM radio
- Recessed alcohol/electric stove
- Recessed propane stove
- Dual voltage refrigerator, 110 VAC-12 VDC
- Teak boarding ladder
- Swim platform, fiberglass with ladder
- Additional automatic electric bilge pump (one standard)
- Under seat storage lockers
- Fire extinguisher, 4#
- Shipping/storage cradle

ENGINE OPTIONS

- Single Model 225 Volvo Stern Drive
 - Single Model 228 MerCruiser Stern Drive
 - Single Model 230 OMC Stern Drive
 - Single Model 260 Volvo Stern Drive
 - Single Model 260 OMC Stern Drive
 - Single Model AQD 40 Volvo Turbocharged Diesel Stern Drive
 - Single Model 270 Crusader V-Drive
 - Single Model 260 MerCruiser Stern Drive
- Displacement Only**
- Single Model 120 Volvo Stern Drive
 - Single Model 120 MerCruiser Stern Drive

NOTE:

Single engine V-drive models utilize a 1-1/4" dia. stainless steel propeller shaft, heavy duty bronze strut, and a bronze rudder with a 1-1/4" dia. rudder shaft.

PERFORMANCE DATA

MODEL: 2687 MONTEREY

Power Model 260 Volvo Stern Drive
 Gear Reduction 1.61:1
 Fuel Load 50 gal.
 Water Load 40 gal.
 Passenger Weight 170 lb.
 Propeller 16 x 17
 Wind Calm
 Temperature 75 degrees F.
 Altitude 590 ft. above sea level

Power Model 225 Volvo Stern Drive
 Gear Reduction 1.61:1
 Fuel Load 94 gal.
 Water Load 46 gal.
 Passenger Weight 170 lb.
 Propeller 16 x 15
 Wind W 5-10 mph
 Temperature 45 degrees F.
 Altitude 590 ft. above sea level

RPM	Trim Angle	Radar Speed (MPH)	Fuel Consumption (GPH)
1000	.75	6.1	1.5
1500	2.5	8.5	2.5
2000	5.5	9.9	4.75
2500	6.5	16.1	7
3000	5	24.7	8.75
3500	3.75	30.3	12.25
4000	3	36.4	17.75
4400	2.75	38.4	21.25

RPM	Trim Angle	Radar Speed (MPH)	Fuel Consumption (GPH)
1000	.75	5.3	1.25
1500	1.75	7.1	2
2000	4	8.1	3.5
2500	5.5	9	5.5
3000	4.25	20.5	8.25
3500	3	26.2	10.5
4000	2	30.1	15.25
4350	1.75	34.5	19.25

The results above were experienced by the specific unit tested.
 Different boats, engines or test conditions could result in varied performance.

CARVER