

# 2866 SANTA CRUZ

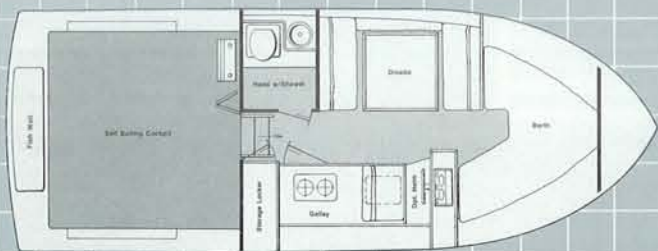
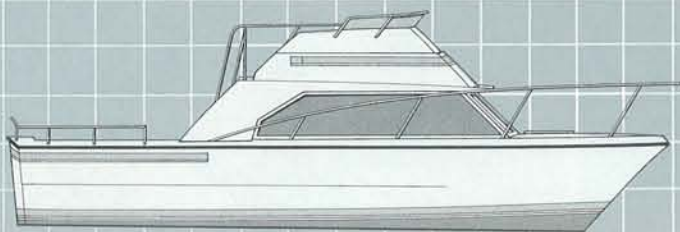

1/4" = 2 Feet

The 28' Santa Cruz combines the comfort and luxury of a pleasure cruiser with all the features of a fisherman's dream. The convertible dinette and V-Berth provide luxurious sleeping space for 4 while the compact, but complete, galley and private enclosed head compartment feature pressure water systems for cruising comfort and convenience. The command bridge with seating for 5 provides ample visibility without sacrificing stability.

A fisherman should not overlook the fish-well with overboard drain and cutting block. The high quality construction and materials that go into each Carver model are found in this efficient fishing machine which offers all the features a fisherman could ever need.

## MODEL 2866 SANTA CRUZ

### Additional Features:

- Pressure water with shower.
- Large dual voltage refrigerator.
- Alcohol stove.
- Complete safety rails including bow rail, taffrail and command bridge safety rails.
- Cabin windows of tempered safety glass encased in welded aluminum extrusion.
- Two automatic bilge pumps.
- Anti-fouling bottom paint.
- Dockside wiring.
- Two large batteries.
- 12 volt cabin and cockpit lighting.
- Self-bailing aft cockpit.

### Available Options:

- Lower station helm and controls
- Bimini top
- Bridge cover
- 3-burner electric stove with oven
- Hot water shower
- Cassette stereo with AM/FM radio
- 20 amp battery charging system
- Propane stove with oven
- Cockpit pressure washdown
- Fiberglass swim platform with ladder
- Bow pulpit
- Engine fresh water cooling

### Profile:

Length ..... 28'4"  
 Beam ..... 10'4"  
 Height (Clearance above water) ..... 9'6"  
 Displacement ..... 7,630 lb.  
 Water System Capacity ..... 30 gal.  
 Fuel System  
     Twin Gas Inboards ..... 160 gal.  
     Twin Diesel Inboards .... 112 gal.  
 Underwater Gear  
     Propeller Shafts  
         Single Inboard ..... 1 3/8" dia. SS  
         Twin Inboard ..... 1 1/4" dia. SS