

**CARVER**



**32**  
**AFT CABIN**



# 32 AFT CABIN



**C**arver builds the 32 Aft Cabin for people who appreciate functional design, quality craftsmanship and outstanding performance in a power pleasure craft. We want to "welcome you aboard" to inspect us fore and aft. Then you can appreciate what a remarkable craft this is.

## PROFILE

The 32 Aft Cabin offers the luxury of two private staterooms, with the master stateroom aft featuring both a single and double berth, a private head compartment and two hanging lockers. The forward stateroom has a V berth and plenty of storage space; the forward head compartment is equipped with a separate stall shower. In the spacious salon, you'll find a convertible sofa/double berth and a hi-lo drop-leaf table. Up on the bridge, there's seating for five and full console instrumentation.

Length .....	32'0"
Beam .....	11'7"
Draft .....	34"
Bridge Clearance .....	11'6"
Displacement .....	12,000 lb
Cabin headroom .....	75"
Sleeping Capacity .....	7
Fuel System Capacity .....	182 gal
Water System	
Total Capacity (hot & cold) .....	84 gal
Underwater Gear	
Propeller shafts .....	1 1/4" dia SS
Rudders .....	Bronze w/1 1/4" SS shafts
Struts .....	Heavy duty bronze alloy

## DESIGN

The Carver 32 hull is a modified V bottom designed for a soft stable ride, superior planing performance and fuel efficiency. The forward stem section provides ample buoyancy and smoothly slices through rough water. The four lifting strakes and wide chines give the lift necessary for planing performance. The aft running bottom gradually decreases in V for additional lift, stability and fuel efficiency. The eight inch deep keel provides excellent low speed tracking performance.

Centerline length .....	32'0"
Waterline length .....	28'1"
Gunwale beam .....	11'7"
Waterline beam (at transom) .....	10'3"

## CONSTRUCTION

Construction of the 32 Aft Cabin hull begins with a fully cured gel coat of 15 mil. thickness. Our craftsmen then use the hand layup method of hull construction. We carefully apply each layer of fiberglass to assure proper resin saturation and consistent hull thickness. This procedure guarantees proper fiberglass to resin ratio and consistent laminate strength throughout.

The 32 Aft Cabin hull consists of several carefully applied layers of 1 1/2 oz. random strand mat and 24 oz. woven roving fiberglass. Generous overlap of the fiberglass layers in the keel and chines assures overall hull strength, impact resistance and structural integrity.

An extensive network of longitudinal stringers and lateral support structures reinforces the fiberglass hull. These supports are bonded to the hull with 24 oz. woven roving fiberglass. A sturdy fiberglass inner liner gives additional structural support to the bow section. The liner interlocks the forward support stringers and engine room bulkhead in place.

The deck and superstructure surfaces are fiberglass reinforced with 3/4" end grain balsa and plywood encapsulated within the fiberglass laminate to ensure the exclusion of moisture. The deck is firmly secured to the hull by fiberglass adhesive and stainless steel screws and sealed by a heavy extruded aluminum gunwale molding.

Every Carver boat is carefully inspected many times during the construction process. We thoroughly inspect every step to guarantee each boat meets our high standards of construction.

## PROPULSION

The Carver 32 Aft Cabin features a choice of engines: the twin model 270 Crusader inboards or twin model 260 Mercruiser inboards. The propulsion system incorporates a 1.9:1 reduction gears, 1 1/4" stainless steel shafts with 18"x18" four-blade propellers.

Cruising speed at 3000 rpm is 21 mph. Top speed is 30 mph.\*

Specifications for diesel propulsion systems are available from your Carver dealer.

## STANDARD FEATURES OF THE CARVER 32 AFT CABIN

A brief tour of the Carver 32 Aft Cabin demonstrates its many standard features. Beginning on the bridge, there are three pedestal seats and an aft bridge bench seat with under seat storage. Total bridge storage is 10.42 cu. ft. The control console instrumentation includes back-lighted fuel, oil pressure and temperature gauges, tachometers and voltmeter.

The skid resistant decks are completely surrounded by 3/8" stainless steel bow rail and safety rails. The spacious aft deck is 5'5"x10'. All deck hardware, including 4 - 10" cleats, 4 - springline cleats and rope deck pipe, is stainless steel. The windows, deck hatches and cabin ports are fully weather sealed and include screens.

Below, the forward stateroom features a V-berth design with filler cushion and 8.71 cu. ft. of hanging locker and shelf storage. The forward head compartment contains a hot/cold shower with fiberglass stall, marine head with 20 gallon holding tank and full mirrored vanity complete with stainless steel sink.

The spacious aft stateroom has a convenient slide-out 6'3"x4'5" double berth along with a 6'3"x3'2" single berth. There is 25.15 cu. ft. of hanging locker and drawer storage. The private aft head compartment has a marine head with 20 gallon holding tank and full mirrored vanity. An electric blower provides ventilation.

The galley and head compartments are served by a fully pressurized 84 gallon hot/cold water system. The spacious galley counter top has sea rails and a deep stainless steel sink. The Princess 3-burner stove/oven is standard. The Norcold double door refrigerator/freezer features 3 removable shelves, in-door storage, crisper and a 40 lb. freezer. The unit operates on 12 volt or 110 volt power.

The salon features over 67 sq. ft. of open floor space. The 6'2" Flexsteel sofa converts to a full size double berth. The custom hi-lo drop leaf table expands to 30"x32" for dining.



The interior decor is available in a choice of colors. The forward V-berth is 3" foam covered with a Scotchgard protected fabric. The fully lined drapes are 100% cotton with Scotchgard protection. The plush 100% nylon carpet is stain and soil resistant.

The navigation and anchor lights of the Carver 32 exceed U.S. Coast Guard standards. Cabin lighting is 12 volt throughout with courtesy lights on the aft deck. Dockside wiring is 110 volt, 30 amp with a 50

foot shore cable. There are seven 110 volt receptables throughout the craft.

Now that you have taken the time and care to learn about our product...we feel you will want to experience it as well. We recommend that you visit your Carver dealer or tour our production facilities in Pulaski, WI, for a thorough inspection of the Carver 32 Aft Cabin.

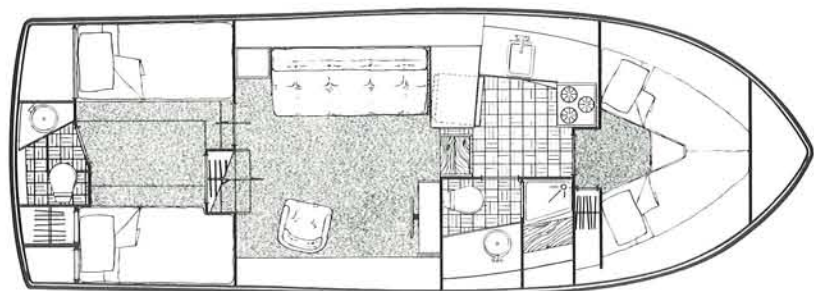

## STANDARD EQUIPMENT

### Exterior

- Bottom paint, anti-fouling
- Bow, aft deck, bridge rails - welded stainless steel
- Foredeck hatch
- Navigation lights
- Command bridge w/helm, seating, W/S
- Helm console w/full instrumentation
- Anti-skid texture fiberglass decks

### Galley & Head Compartment

- Pressure water system
- 3-Burner electric stove w/oven
- Refrigerator, dual voltage
- Shower, hot water
- Two heads, marine
- Hot water heater, 12 gallon

### Functional/Safety

- Horn, single trumpet
- Bilge pump, automatic (2)
- Trim tabs, electric/hydraulic

### Electrical

- Heavy duty batteries (2)
- Dockside wiring, 30 amp, 110 VAC
- 12V wiring w/thermal breakers
- Cabin lighting, 12 volt

### Interior

- Color coordinated carpeting, draperies, and upholstery
- Two private staterooms
- Teak parquet floor in galley & head

## SELECTED OPTIONS

### Helm Equipment

- Lower station helm & controls
- Engine synchronizer
- 7" spotlight - electric remote control
- Cigar lighter
- Compass
- Engine hour meters
- Horn - electric dual trumpet

### Seating

- Pilot seat at lower station
- Salon chair(s)

### Galley & Interior

- Dry bar w/bottle & glass storage
- 3-burner propane stove w/oven
- Microwave oven & electric stove
- Shore water connection
- Cassette stereo w/AM-FM radio
- Air conditioning w/reverse cycle heat

### Heads

- Vac-u flush heads w/holding tanks
- Crown electric heads w/holding tanks

### Electrical

- 7.5 KW gasoline generator
- Dual dockside - 110V-30A
- 20A battery charging system

### Exterior

- Fiberglass swim platform w/ladder
- Fiberglass bow pulpit
- Bridge and aft deck carpet

### Propulsion

- Engine fresh water cooling

### Weather Covers

- Bimini top w/full enclosure
- Bridge cover



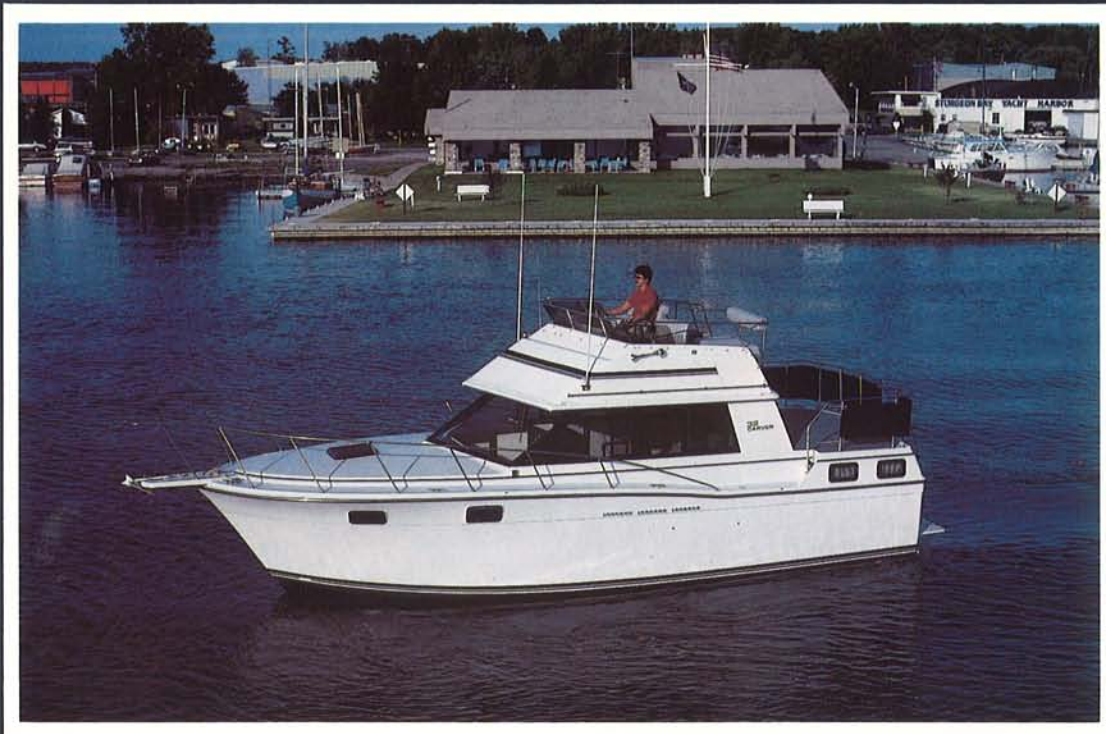

# CARVER

CARVER CORPORATION  
Industrial Drive  
Pulaski, WI 54162

For additional information on any Carver cruiser, or to arrange your personal tour of our facilities in Pulaski, call us at 1-800-558-8190 (in Wisconsin 1-800-242-4546; in Canada, 1-800-351-0644) between 8 and 5, CST. Or write Carver, Pulaski, Wisconsin 54162.

\*These results were experienced by the specific unit tested. Different boats, engines, load or test conditions could result in varied performance.

Carver reserves the right to change without notice: price, color, materials, equipment specifications or models of its cruiser line. Models may also be discontinued without obligation to previous purchasers.