

CARVER



**36
MARINER**

36 MARINER



The Carver 36 Mariner is fast becoming the standard by which other pleasure crafts are measured. Its functional design, quality construction and proven performance put it in a class by itself. We want you to spend a little time "on board"...reading this comprehensive description of the Mariner. Then you can begin to appreciate what a truly remarkable craft it is.

PROFILE

Our 36' Mariner is the perfect yacht for luxurious living and gracious entertaining. The bridge seats 8 and features a double sun lounge aft. The walk-around side decks give easy access to a second sun lounge on the foredeck, while the large cockpit aft boasts a convenient transom door. Below, the salon provides more than 120 sq. ft. of living area and is appointed with two spacious lounges, including a dinette that converts to a double berth. A wet bar and complete galley are standard. The master stateroom forward has a wide double berth, a vanity and two hanging lockers, plus a private entrance to the shower-equipped head compartment. The guest stateroom offers upper and lower berths and a vanity.

Length	35'7"
Beam	12'6"
Draft	38"
Bridge Clearance	13'6"
Displacement	19,500 lb
Cabin Headroom	75"
Sleeping Capacity	8
Fuel System	274 gal
Water System	
Total Capacity (hot & cold)	100 gal
Underwater Gear	
Propeller shafts	1 3/8" dia SS
Rudders	Bronze w/1 1/4" SS shafts
Struts	Heavy duty bronze alloy

DESIGN

The Carver 36 hull is designed for a smooth stable ride, superior planing performance and fuel efficiency. The fine V-shaped bow entry and round bilge reduce overall drag on the hull. Wide chines, running from midship to the transom, provide the lift necessary for planing performance. The aft running bottom, gradually decreasing in V to 8°, creates

additional lift, stability and fuel efficiency. The 14" deep keel provides superior tracking performance while eliminating low speed wandering.

Centerline length	35'7"
Waterline length	31'4"
Gunwale beam	12'6"
Waterline beam (at transom)	11'0"

CONSTRUCTION

Hull construction of the 36 Mariner begins with a fully cured gel coat of 15 mil. thickness. Carver craftsmen then use the hand layup method of hull construction. Each layer of fiberglass is carefully applied to assure proper resin saturation and consistent hull thickness. This procedure guarantees the proper fiberglass to resin ratio assuring consistent laminate strength throughout.

The hull consists of several carefully applied layers of 1 1/2 oz. random strand mat and 24 oz. woven roving fiberglass. Generous overlap of these layers in the keel and chines increases hull strength, impact resistance and overall structural integrity.

The fiberglass hull is strongly reinforced with an extensive network of longitudinal and lateral stringers. The stringer system is a fiberglass hat section, bonded to the hull by 24 oz. woven roving fiberglass. A strong fiberglass liner gives additional structural support to the bow section, interlocking the forward stringers and lateral bulkhead in place. One-half inch end grain balsa is encapsulated into the hull sides for additional support.

Superstructure and deck surfaces are fiberglass reinforced with 3/4" end grain balsa and 3/4" plywood encapsulated within the fiberglass laminate to ensure the exclusion of moisture. The deck is firmly secured to the hull by fiberglass adhesive and stainless steel screws and sealed by a heavy vinyl/stainless steel gunwale molding.

Every Carver boat is carefully inspected many times during the construction process. We thoroughly inspect every step to guarantee each boat meets our high standards of construction.

PROPULSION

The Carver 36 Mariner comes with a choice of engines: the twin V-drive 350 Crusader inboards or twin V-drive 340 Mercruiser inboards. The pro-

pulsion system incorporates 2.5:1 reduction gears, 1 3/8" stainless steel shafts with 22"x22" four blade propellers.

Cruising speed at 3000 rpm is 19 mph. Top speed is 30 mph.*

STANDARD FEATURES OF THE CARVER 36 MARINER

A brief inspection of the Carver 36 Mariner demonstrates its many standard features. Starting on the spacious bridge, there is seating for 9, including a slide/swivel pilot seat. A large starboard bridge lounge has 15.56 cu. ft. of under seat storage. The aft double sun lounge/seat is 6'2" in length. After bridge storage totals 6 cu. feet. Full instrumentation on the control console includes back-lighted fuel, oil pressure, temperature gauges, tachometers and voltmeter. The optional aluminum electronics arch can accommodate antennae, searchlights and navigational gear.

The skid resistant decks are completely surrounded by welded stainless steel bow rail and safety rails. Spacious side decks lead to the 41"x6'6" foredeck sun lounge. All deck hardware, including 4 - 10" cleats, 4 - springline cleats and rope deck pipe, is stainless steel. Windows, deck hatches and cabin ports are fully weather-sealed and include screens. Below, the master stateroom features a large double berth and full mirrored vanity with stainless steel sink. Two large hanging lockers, drawers and vanity provide 27.32 cu. ft. of storage space.

The starboard guest stateroom has two 28"x6'4" single berths with 10.8 cu. ft. underberth storage. A large hanging locker and cabinet provide an additional 8.1 cu. ft. of storage.

The head compartment features a hot/cold shower with fiberglass stall, marine head with 40 gallon holding tank and full mirrored vanity with stainless steel sink. There is 4.7 cu. ft. of under vanity storage. An electric blower provides ventilation.

A 100 gallon pressurized hot/cold water system serves the head compartment, vanities, wet bar and galley. Hot water is provided by an electric 110 volt water heater. While underway, a heat exchanger supplies hot water from the engine cooling system.

The spacious galley counter top has a deep dual basin stainless steel sink. The Princess 3-burner stove/oven is standard. The Norcold double door refrigerator/freezer features 3 removable shelves, in-door storage, crisper and a 40 lb. freezer. This unit operates on 12 or 110 volt power.

The spacious salon measures 11'3"x12'. The large dinette converts to a 48"x7'2" double berth. Port, there is a large L-shaped lounge opening to a double berth, wet bar and salon access ladder to the bridge. The large sliding glass door leads to the cockpit. Access to the bridge is via port and starboard bridge ladders.

The interior decor includes a choice of colors. Berths are 3" foam covered with a fine quality Scotchgard protected fabric. The fully lined drapes

are all cotton with Scotchgard protection. The 100% plush nylon carpet is stain and soil resistant.

The Carver 36 Mariner's navigation and anchor lights exceed U.S. Coast Guard standards. Cabin lighting is 12 volt throughout with courtesy lights on the bridge, cockpit and master stateroom. Dockside wiring is 110 volt, 30 amp with a 50 foot shore cable. Seven 110 volt receptacles are located throughout the craft.

Now that you have taken the time and care to learn about our product...we feel that you will want to experience it as well. We recommend that you visit your Carver dealer or tour our production facilities in Pulaski, WI, for a thorough inspection of the Carver 36 Mariner.

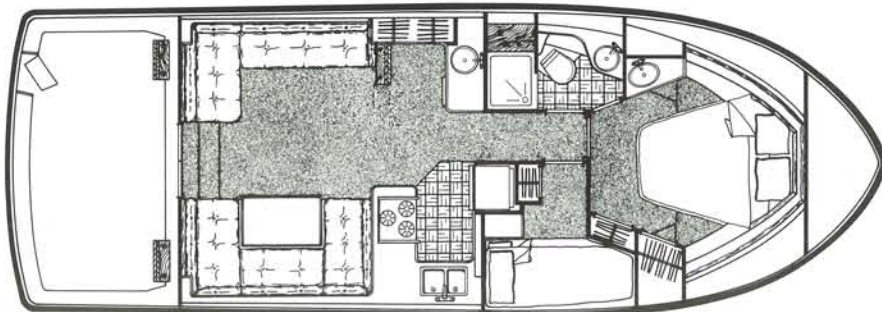

STANDARD EQUIPMENT

Exterior

- Heavy duty gunnel molding
- Bottom paint, anti-fouling
- Bow rail, safety rails - welded SS
- Foredeck hatch
- Navigation lights
- Command bridge w/helm & seating
- Helm console w/full instrumentation
- Anti-skid texture fiberglass decks
- Transom door
- Foredeck sun lounge
- Skiff windshield

Galley & Head Compartment

- Pressure water system
- Hot water heater, 10 gallon
- Stove w/oven, electric 3-burner
- Refrigerator, dual voltage
- Head, marine
- Shower, fiberglass stall w/bifold door

Functional/Safety

- Bilge pump, automatic (2)
- Horn, dual trumpet electric
- Trim tabs, electric/hydraulic

Electrical

- Heavy duty batteries (2)
- Dockside wiring, 30 amp, 110 VAC
- 12 volt wiring w/thermal breakers
- Cabin lighting, 12 volt

Interior

- Color coordinated carpeting, draperies, and upholstery
- Wet bar w/bottle storage

SELECTED OPTIONS

Helm Equipment

- 7" spotlight - electric remote control
- Engine synchronizer
- Cigar lighter
- Compass
- Engine hour meters

Galley & Interior

- 3-burner propane stove w/oven
- Microwave oven & electric stove
- AM-FM receiver w/stereo cassette
- Air conditioning w/reverse cycle heat
- Shore water connection
- Icemaker

Weather Covers

- Bimini top w/full enclosure
- Venturi windshield

Head

- Crown electric head w/holding tank
- Electric flush head w/holding tank

Electrical

- 7.5 KW gasoline generator
- Dual dockside, 110V-30A
- 20 amp battery charging system

Exterior

- Cockpit pressure sea water washdown
- Fiberglass swim platform w/ladder
- Fiberglass bow pulpit
- Bridge & aft deck carpet
- Electronics arch

Propulsion

- Engine fresh water cooling
- Fuel selector valves

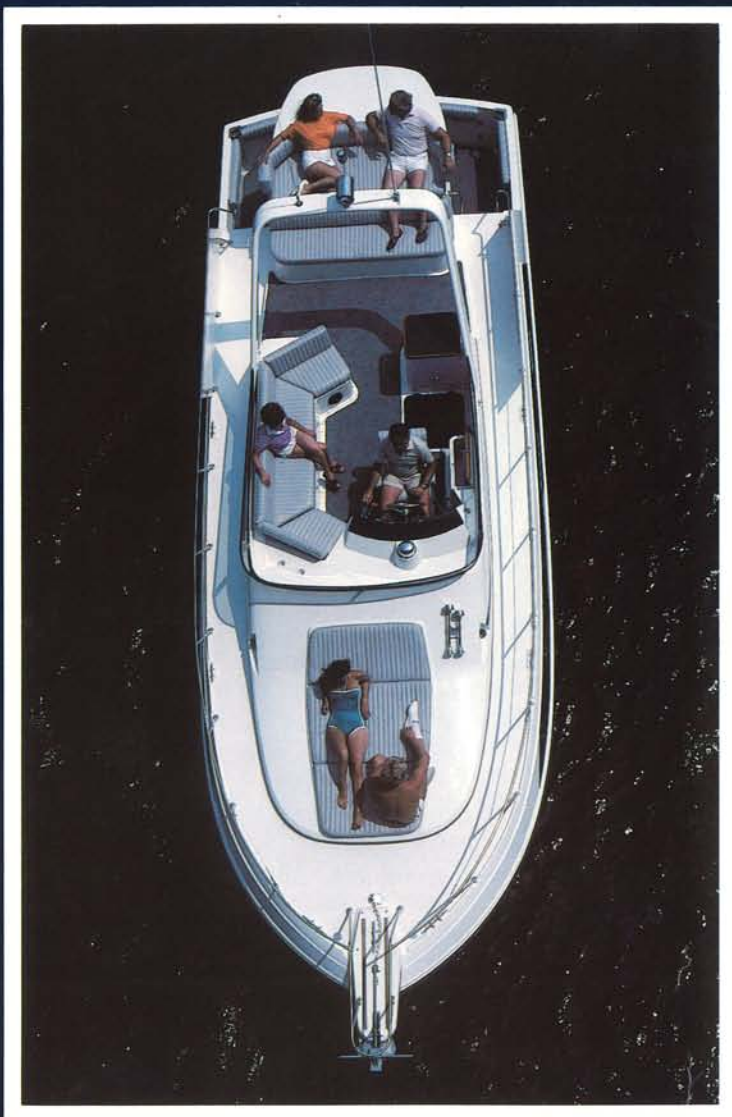

CARVER ADDS
THE FINISHING TOUCHES.

*Nice Touch,
Carver.*

CARVER

CARVER BOAT CORPORATION
Industrial Drive
Pulaski, WI 54162

For additional information on any Carver cruiser, or to arrange your personal tour of our facilities in Pulaski, call us at 1-800-558-8190 (in Wisconsin 1-800-242-4546; in Canada, 1-800-351-0644) between 8 and 5, CST. Or write Carver, Pulaski, Wisconsin 54162.

*These results were experienced by the specific unit tested. Different boats, engines, load or test conditions could result in varied performance.

Carver reserves the right to change without notice: price, color, materials, equipment specifications or models of its cruiser line. Models may also be discontinued without obligation to previous purchasers.