

CARVER



32
MARINER

32 MARINER



The Carver 32 Mariner is a very special craft. It's the perfect combination of distinctive styling, expert marine design and proven performance. Everything pleasure crafts should be. We invite you to "come aboard" the 32 Mariner, and see for yourself... what a special craft it is.

PROFILE

Our 32' Mariner is a plush, floating home on a seagoing hull. The spacious bridge provides a comfortable all-weather command center and is accessible from the main cabin or cockpit. The salon has party-size space, with seating for 8 people. The single level floor plan includes the owner's stateroom with a large double berth and private entrance to the roomy head compartment. The complete galley includes a double-door refrigerator/freezer plus spacious storage areas.

Length	32'3"
Beam	12'4"
Draft	33"
Bridge Clearance	10'10"
Displacement	12,000 lb
Cabin Headroom	6'3"
Sleeping Capacity	6
Fuel System	192 gal
Water System	
Total Capacity (hot & cold)	111 gal
Underwater Gear	
Propeller shafts	1 1/4" dia SS
Rudders	Bronze w/1 1/4" SS shafts
Struts	Heavy duty bronze alloy

DESIGN

The Carver 32 hull is a modified V bottom designed for a soft stable ride, superior planing performance and fuel efficiency. The forward stem section provides ample buoyancy and smoothly slices through rough water. The aft running bottom gradually decreases in V for additional lift, stability and fuel efficiency. The twelve inch deep keel provides excellent low speed tracking performance.

Centerline length	32'3"
Waterline length	27'6"
Gunwale beam	12'4"
Waterline beam (at transom)	10'7"

CONSTRUCTION

Construction of the 32 Mariner hull begins with a fully cured gel coat of 15 mil. thickness. Our craftsmen then use the hand layup method of hull construction. We carefully apply each layer of fiberglass to assure proper resin saturation and consistent hull thickness. This procedure guarantees the proper fiberglass to resin ratio assuring consistent laminate strength throughout.

The 32 Mariner hull consists of several carefully applied layers of 1 1/2 oz. random strand mat and 24 oz. woven roving fiberglass. Generous overlap of the fiberglass layers in the keel and chines assures overall hull strength, impact resistance and structural integrity.

An extensive network of fiberglass longitudinal stringers and lateral support structures reinforce the fiberglass hull. These supports are bonded to the hull with 24 oz. woven roving fiberglass. A sturdy fiberglass inner liner gives additional structural support to the bow section, interlocking the forward support stringers and aft galley bulkhead in place.

The deck and superstructure surfaces are fiberglass reinforced with 3/4" end grain balsa and plywood encapsulated within the fiberglass laminate to ensure the exclusion of moisture. The deck is firmly secured to the hull by fiberglass adhesive and stainless steel screws and sealed by a heavy extruded aluminum gunwale molding.

Every Carver boat is carefully inspected many times during the construction process. We thoroughly inspect every step to guarantee each boat meets our high standards of construction.

PROPULSION

The Carver 32 Mariner comes with a choice of engines: the twin V-drive 270 Crusader inboards or the twin V-drive 260 Mercruiser inboards. The propulsion system includes 1.99:1 reduction gears, 1 1/4" stainless steel shafts and 18" x 18" four blade propellers.

Cruising speed at 3000 rpm is 18 mph. Top speed is 31 mph.*

STANDARD FEATURES OF THE CARVER 32 MARINER

A brief inspection of the Carver 32 Mariner demonstrates its many standard features. The command bridge features a pedestal slide/swivel pilot seat and console instrumentation including back-lighted fuel, oil pressure and temperature gauges, tachometers, and voltmeters. The spacious port and aft lounges seat six comfortably. Storage is over 22 cu. ft. including a lockable electronics locker.

The bridge and side decks are surrounded by 3/8" welded stainless steel safety rails with a life-line midrail support. All deck and cockpit surfaces are textured and skid resistant. The foredeck has a spacious 6'2" x 29" sun lounge. The twin foredeck hatches, windows and cabin entry doors are weather sealed and include screens. All deck hardware, including 3-12" cleats, 4 springline cleats and rope deck pipe, is stainless steel.

Port and starboard ladders provide easy access to the bridge. The 5'4" x 10'4" cockpit features a fiberglass transom door and removable coaming pads. There is a sunshade over the sliding glass cabin entry door.

In the spacious 8'9" x 10'10" salon, a large dinette seats 6 and converts to a 44" x 6'7" double berth. The starboard sofa converts to an additional double berth. There is over 30 cu. ft. of hanging locker and under dinette storage. A convenient ladder provides salon to bridge access.

The head compartment has a full vanity with stainless steel sink and marine head with 40 gallon holding tank. The hot/cold shower features a fiberglass stall with bi-fold door. Under vanity locker and mirrored cabinets provide 5.9 cu. ft. of storage.

The fully pressurized 111 gallon hot/cold water system serves the head compartment and galley. Hot water is provided by an 11 gallon water heater. The spacious galley has a deep dual basin stainless steel sink and Princess 3-burner electric stove/oven. The Norcold double door refrigerator/freezer has 3 removable shelves, in-door storage, crisper, and a 40 lb. freezer. This unit operates on 12 or 110 volt power. Total galley storage is 17.1 cu. ft.

The 32 Mariner's forward stateroom features a large 48" x 6'6" double berth, 53.5 cu. ft. of hanging, locker and underberth storage and private head compartment access.

The interior decor features a choice of colors. All berths are 4" filled polyfoam, covered with a durable Scotchgard protected fabric. The 100% nylon carpet is soil and stain resistant. The fully lined 100% cotton drapes are Scotchgard protected. Salon windows are equipped with mini-blinds.

The navigation and anchor lights of the 32 Mariner exceed U.S. Coast Guard standards. Cabin lighting

consists of 12 volt fluorescent and decorative barrel lamps. Dockside wiring is 110 volt, 30 amp with a 50 foot shore cable. There are seven 110 volt receptacles located throughout the craft.

Now that you have taken the time to read about our product... we believe you will want to experience it as well. We recommend that you visit your Carver dealer, or tour our production facilities in Pulaski, WI, for a thorough inspection of the Carver 32 Mariner.

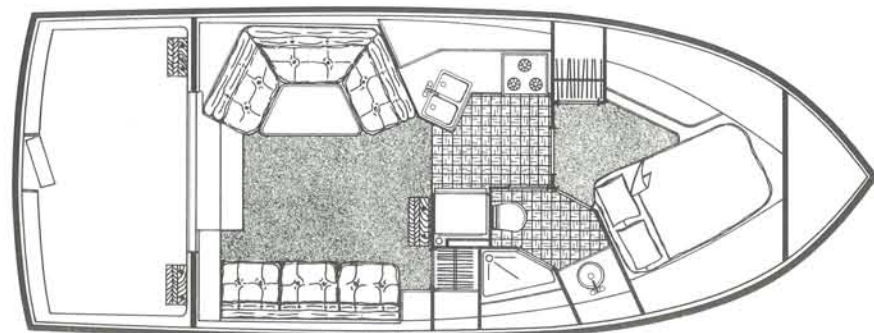

STANDARD EQUIPMENT

Exterior

- Bottom paint, anti-fouling
- Bow rail, safety rails - welded SS
- Foredeck hatch (2)
- Navigation lights
- Command bridge w/helm & seating
- Helm console w/full instrumentation
- Anti-skid texture fiberglass decks
- Transom door
- Foredeck sun lounge
- Skiff windshield

Galley & Head Compartment

- Pressure water system
- Hot water heater, 11 gallon
- Stove w/oven, electric 3-burner
- Refrigerator, dual voltage
- Head, marine
- Shower, fiberglass stall w/bifold door

Functional/Safety

- Bilge pump, automatic (2)
- Horn
- Trim tabs, electric/hydraulic

Electrical

- Heavy duty batteries (2)
- Dockside wiring, 30 amp, 110 VAC
- 12 volt wiring w/thermal breakers
- Cabin lighting, 12 volt

Interior

- Color coordinated carpeting, draperies, and upholstery
- Teak parquet floor in galley and head

SELECTED OPTIONS

Helm Equipment

- 7" spotlight - electric remote control
- Engine synchronizer
- Cigar lighter
- Compass
- Engine hour meters
- Horn - electric dual trumpet
- Venturi windscreen

Galley & Interior

- 3-burner propane stove w/oven
- Microwave oven & electric stove
- AM-FM receiver w/stereo cassette
- Air conditioning w/reverse cycle heat
- Monitors - water & holding tanks
- Wet bar w/bottle & glass storage
- Icemaker for wet bar

Head

- Vac-u flush head w/holding tank
- Crown electric head w/holding tank

Exterior

- Cockpit pressure sea water washdown
- Fiberglass swim platform w/ladder
- Fiberglass bow pulpit
- Bridge & cockpit carpet

Weather Covers

- Bimini top w/full enclosure
- Bridge helm & seat covers

Electrical

- 7.5 KW Kohler gasoline generator
- Dual dockside, 110V-30A
- 20 amp battery charging system

Propulsion

- Engine fresh water cooling

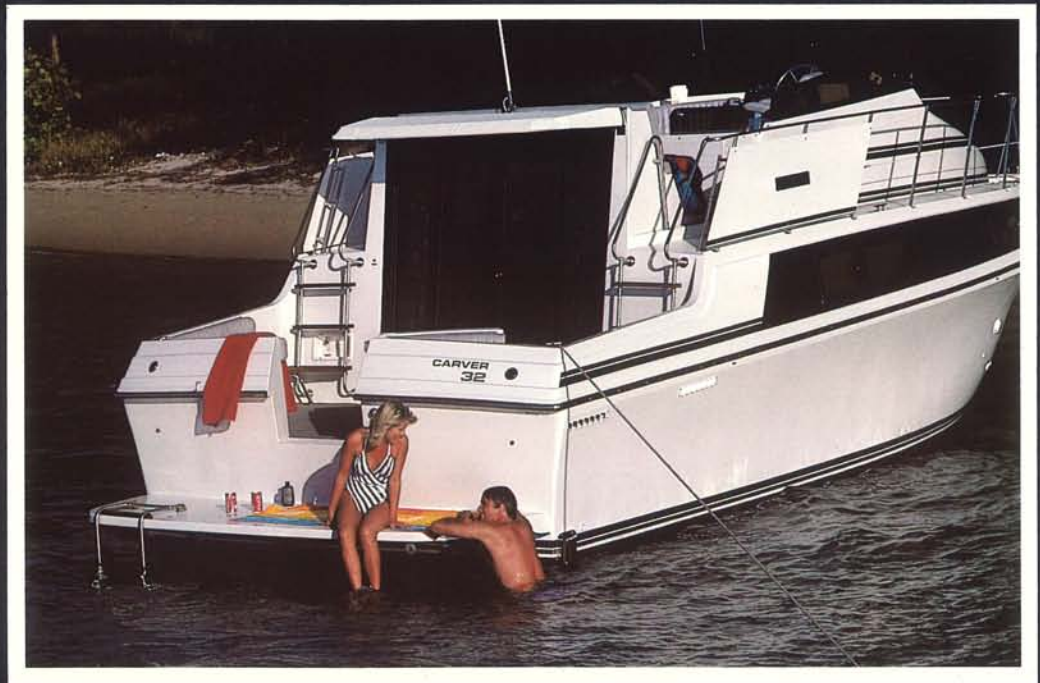
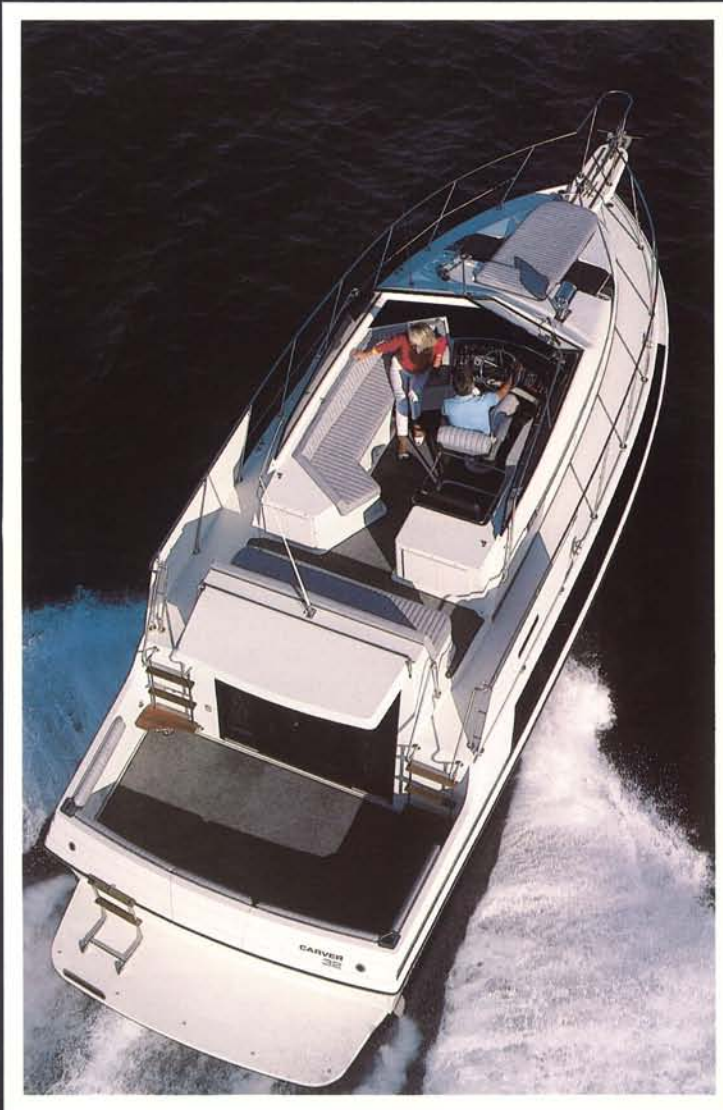

CARVER

CARVER CORPORATION
Industrial Drive
Pulaski, WI 54162

For additional information on any Carver cruiser, or to arrange your personal tour of our facilities in Pulaski, call us at 1-800-558-8190 (in Wisconsin 1-800-242-4546; in Canada, 1-800-351-0644) between 8 and 5, CST. Or write Carver, Pulaski, Wisconsin 54162.

*These results were experienced by the specific unit tested. Different boats, engines, load or test conditions could result in varied performance.

Carver reserves the right to change without notice: price, color, materials, equipment specifications or models of its cruiser line. Models may also be discontinued without obligation to previous purchasers.