

27

Santego

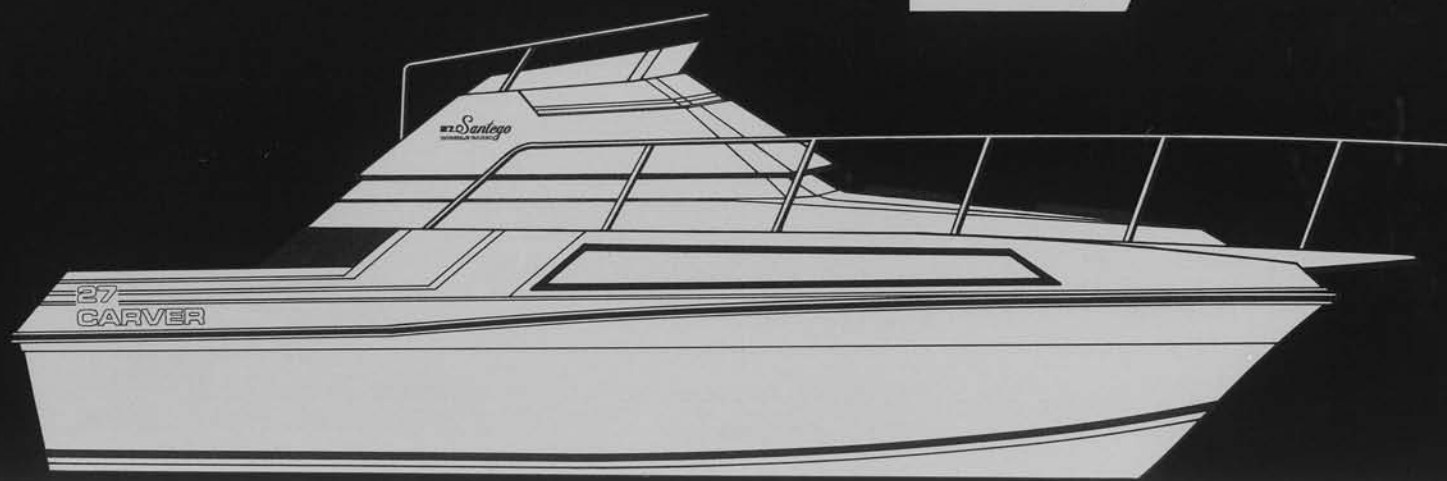

The Carver 27 Santego combines amazing liveability with the sleek styling of a 27' cruiser. The Santego offers double cabin privacy with more sleeping room than any other boat in its class. The roomy cabin features a dinette/lounge that converts

to a double berth, bringing the sleeping capacity to six. Topside, the bridge comfortably seats five adults. Foredeck sun lounges, bow pulpit and swim platform add to the standard amenities.

SPECIFICATIONS

Length	27'3"
Beam	10'0"
Draft	32"
Bridge Clearance	9'2"
Displacement	8,400 lb.
Cabin Headroom	75"
Sleeping Capacity	6
Fuel System Capacity	98 gal.
Water System	
Total Capacity	
(hot & cold)	41 gal.

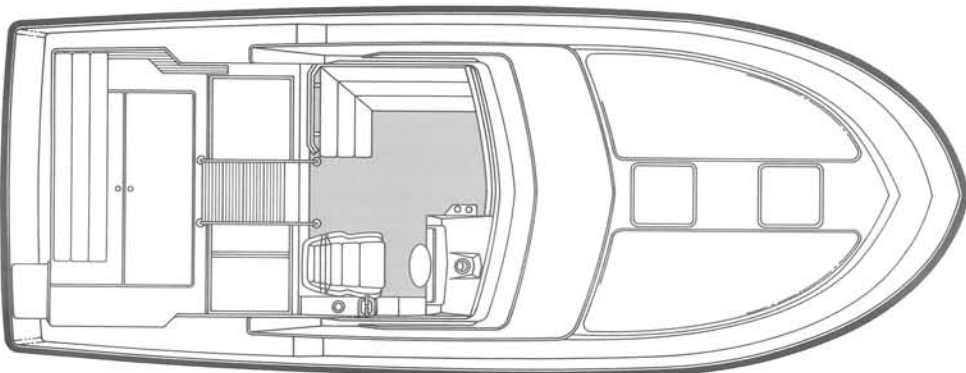
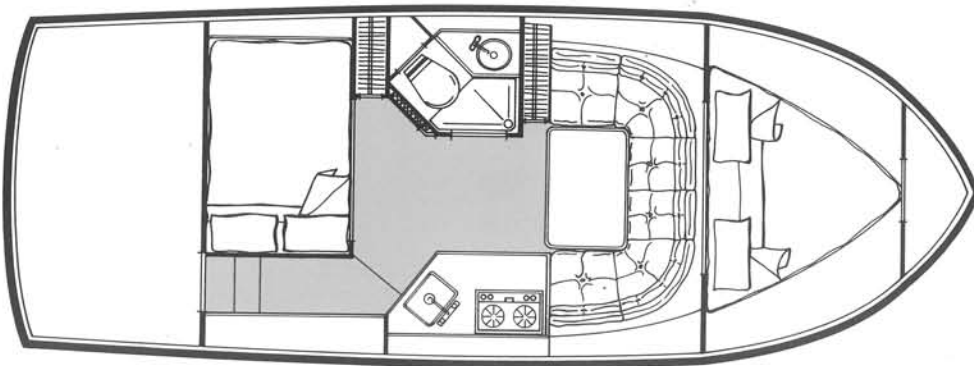

Carver 27 Santego

STANDARD EQUIPMENT

Exterior

Welded SS bow rail and safety rails with SS fittings
Two foredeck hatches
Navigation lights (NMMA approved)
Teleflex console instrumentation includes back-lighted fuel and oil pressure gauges, tachometer, voltmeter and temperature gauge
Adjustable helm seat
Cockpit lounge
Self-bailing cockpit
SS deck hardware, including foredeck mooring bitt, two 8" springline cleats and two 8" stern cleats
Fiberglass bow pulpit
Anti-skid fiberglass decks
Fiberglass swim platform with ladder
Twin foredeck sun lounges
Venturi windshield
Galvanic isolator

Propulsion

Twin 171 Volvo Duo-Prop, 152 cu. in. Volvo block
Twin 180 MerCruiser stern drive, 224 cu. in. MerCruiser block, 4-barrel carburetion
Propellers, 14" x 19" 3 blade
Twin 205 MerCruiser stern drive, 262 cu. in. GM block, 4-barrel carburetion
Propellers, 13 $\frac{3}{4}$ " x 21" 3 blade
Performance data* with Twin 180 MerCruisers:
Cruising speed at 3200 rpm... 20.5 to 22.5 mph
Wide open throttle _____ 35 to 37 mph

Design

The Carver 27 running bottom incorporates a modified V-warped plane design that features a sharp entry at the stem (forward) which cuts rough water for a soft ride. Four lifting strakes and wide hard chines are designed to provide additional lift and stability. Further aft, the hull gradually decreases in degree of V to provide efficient, fuel-saving performance. Deadrise at transom is 8°.

Waterline length _____ 22'6"
Waterline beam at transom _____ 8'3"
Freeboard aft _____ 39"
Freeboard forward _____ 51"

Construction

Hand layup method of construction guarantees the proper fiberglass to resin ratio, assuring consistent laminate strength throughout. The hull is made up of several carefully applied layers of 1½ oz. random strand mat and 24 oz. woven roving fiberglass. Generous overlap of these layers in the keel and chines increases hull strength, impact resistance and overall structural integrity.

The fiberglass hull is strongly reinforced with an extensive network of longitudinal and lateral stringers bonded to the hull by 24 oz. woven roving fiberglass. A strong fiberglass liner gives additional structural support to the bow section, bonding the forward stringers and engine room bulkhead in place.

Superstructure and deck surfaces are fiberglass-reinforced with ½" end grain balsa; and ½" plywood is used in areas of hardware installation. The deck is firmly secured to the

hull by fiberglass adhesive and SS screws, and sealed by a heavy gunwale molding.

Every Carver boat is thoroughly inspected at each step of the construction process to guarantee it meets our demanding, high-quality standards.

Galley and Head Compartments

Pressurized 41 gal. hot/cold water system
6 gal. water heater
2-burner recessed alcohol stove
Upright ice chest with removable shelf and in-door storage
Mansfield marine head with 9 gal. holding tank
Hot and cold pressure shower
Midcabin sofa bed
Convenient vanity with pressure water, SS sink and mirror
Engine heat exchanger

Functional/Safety

Windows, lightly tinted, with screens
Automatic, electric bilge pump
Gravity bilge ventilation with electric bilge blower
Single-trumpet electric horn
Carbon monoxide monitoring system

Electrical

Two marine-quality batteries with cold-cranking amperage of 405 (reserve capacity 153 minutes)
Dockside wiring, 30 amp, 110 VAC with a 50 ft. shore cable
Cabin lighting, 12V
U.S. Coast Guard-approved navigation and anchor lights

Interior

Dinette/lounge converts to double berth
Private midship stateroom with double berth and 6'3" headroom
Forward V-berth
Color-coordinated carpeting, draperies and upholstery
Plush, stain- and soil-resistant 100% nylon carpeting
Fully lined 100% cotton drapes protected by Scotchguard

SELECTED OPTIONS

Helm Equipment

5" or 7" spotlight - electric remote control
Bennett electric/hydraulic trim tabs
Electric dual-trumpet horn
Compass
Engine hour meters
Synchronizer for twin gas engines

Galley and Interior

Norcold dual-voltage refrigerator
Princess recessed alcohol/electric stove
Kenyon recessed propane stove
Cassette stereo with AM/FM radio
Air conditioning with reverse cycle heat
Decorator pillows

Weather Covers

Bimini top with boot
Bimini top with full enclosure

Heads

Electric head
Raritan crown electric head
15 gal. auxiliary holding tank
Overboard discharge for head (coastal markets only)

Electrical

Two heavy-duty batteries (530 cold cranking amps)
20 amp battery charging system
Dual dockside, 110V-30A
Voltmeter/ammeter kit
Dockside adaptors

Exterior

Additional automatic bilge pump
Cockpit pressure seawater washdown
Two ski eyes in transom
4 lb. portable fire extinguisher
Fireboy Halon fire extinguisher system
Heavy-duty gunwale molding
Exterior cockpit carpet

Propulsion

Shipping cradle
Engine fresh water cooling for MerCruiser stern drive
Fuel tank selector valves

For more information on the spacious, high-styled 27 Santego, see your Carver dealer. We also invite you to visit our production facilities in Pulaski, WI. Call toll free 800/558-8190. (Wisconsin 800/242-4546; Canada 800/351-0644)

*These results were experienced by the specific unit tested. Different boats, engines, loads or test conditions could result in varied performance.

Information accurate at time of printing. Carver Boat Corporation reserves the right to change without notice; price, color, materials, equipment specifications or models. Models may also be discontinued without obligation to previous purchasers. All Carver yachts and cruisers carry a limited warranty. See your dealer for current specifications. 8/87

CARVER

Carver Boat Corporation
Industrial Drive
Pulaski, Wisconsin 54162

