

27

Santego

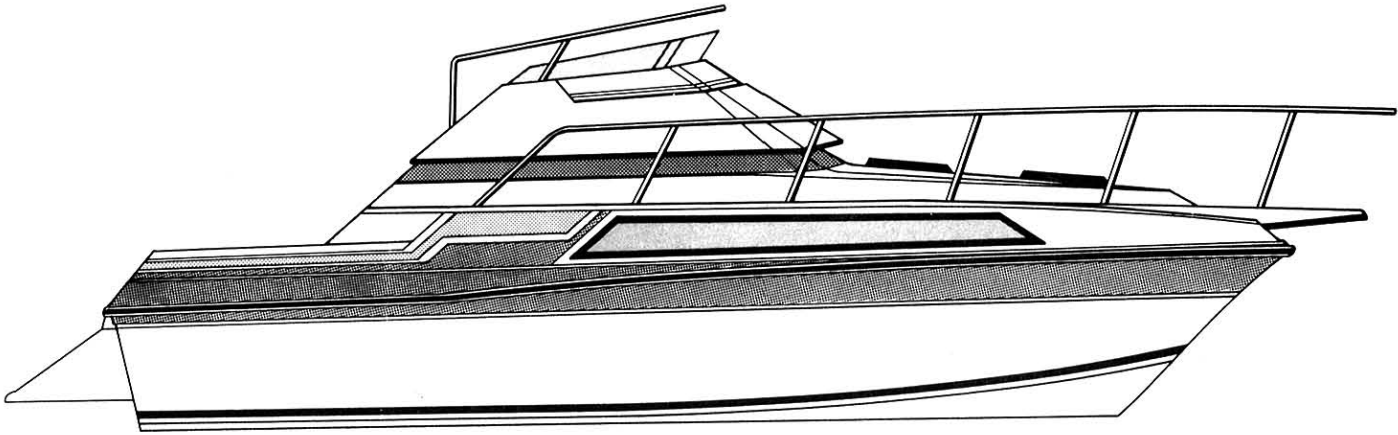

The Carver 27 Santego combines amazing liveability with the sleek styling of a 27' cruiser. The Santego offers double cabin privacy with more sleeping room than any other boat in its class. The roomy cabin features a dinette/lounge that converts

to a double berth, bringing the sleeping capacity to six. Topside, the bridge comfortably seats five adults. Foredeck sun lounges, bow pulpit and built-in swim platform add to the standard amenities.

SPECIFICATIONS

LOH	27'3"
Standard LOA	31'7"
Maximum LOA	31'7"
Beam	10'0"
Draft	32"
Bridge Clearance	9'2"
Deadrise at Transom	19°
Dry Weight (approx.)	8,400 lb.
Cabin Headroom	6'3"
Sleeping Capacity	6
Fuel System Capacity	98 gal.
Water System	41 gal.
Waste Capacity	9 gal.

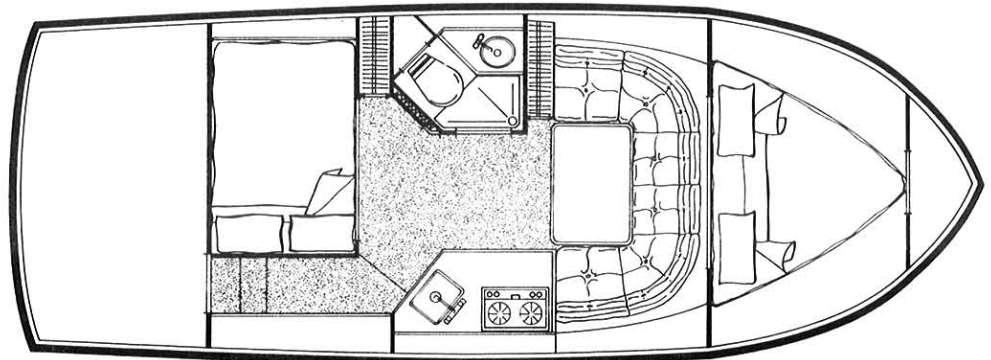
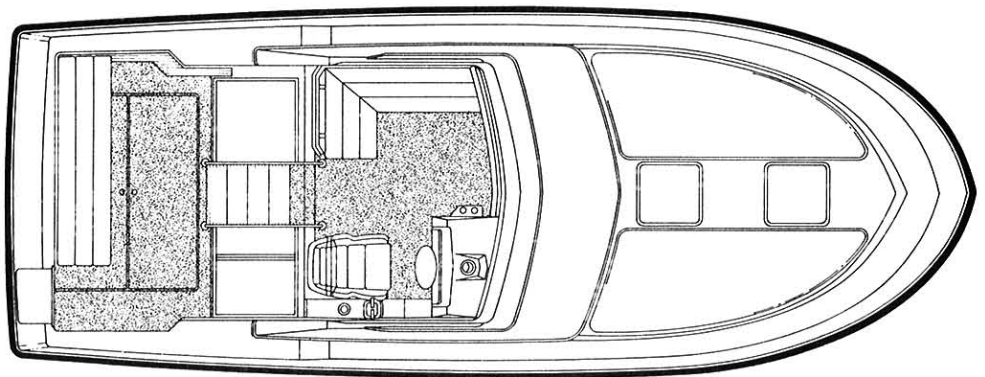

Carver 27 Santeago

STANDARD EQUIPMENT

Exterior

Welded SS bow rail and safety rails with SS fittings
Two foredeck hatches
Navigation lights (NMMA approved)
Teleflex console instrumentation includes back-lighted fuel and oil pressure gauges, tachometer, voltmeter and temperature gauge
Adjustable helm seat
Cockpit lounge
Self-bailing cockpit
SS deck hardware, including foredeck mooring bit, two 8" springline cleats and two 8" stern cleats
Fiberglass bow pulpit
Anti-skid fiberglass decks
Fiberglass swim platform with ladder
Twin foredeck sun lounges
Venturi windshield

Propulsion

Single stern drive - gas
7.4L Bravo I MerCruiser
AQ740 Volvo Duo-Prop
Twin stern drive - gas
AQ171 Volvo
4.3LX MerCruiser
AQ205 Volvo Duo-Prop
Twin stern drive - diesel
AQAD 31 Volvo Duo-Prop

Design

The Carver 27 running bottom incorporates a modified V-warped plane design that features a sharp entry at the stern (forward) which cuts rough water for a soft ride. Four lifting strakes and wide hard chines are designed to provide additional lift and stability. Further aft, the hull gradually decreases in degree of V to provide efficient, fuel-saving performance.

Waterline length _____ 22'6"
Waterline beam at transom _____ 8'3"
Freeboard aft _____ 39"
Freeboard forward _____ 51"

Construction

Hand layup method of construction guarantees the proper fiberglass to resin ratio, assuring consistent laminate strength throughout. The hull is made up of several carefully applied layers of 1½ oz. random strand mat and 24 oz. woven roving fiberglass. Generous overlap of these layers in the keel and chines increases hull strength, impact resistance and overall structural integrity.

The fiberglass hull is strongly reinforced with an extensive network of longitudinal and lateral stringers bonded to the hull by 24 oz. woven roving fiberglass. A strong fiberglass liner gives additional structural support to the bow section, bonding the forward stringers and engine room bulkhead in place.

Superstructure and deck surfaces are fiberglass-reinforced with ½" end grain balsa; and ½" plywood is used in areas of hardware

installation. The deck is firmly secured to the hull by fiberglass adhesive and SS screws, and sealed by a heavy gunwale molding.

Every Carver boat is thoroughly inspected at each step of the construction process to guarantee it meets our demanding, high-quality standards.

Galley and Head Compartments

Pressurized 41 gal. hot/cold water system
6 gal. water heater
2-burner recessed alcohol stove
Upright ice chest with removable shelf and in-door storage
Mansfield marine head with 9 gal. holding tank
Hot and cold pressure shower
Midcabin sofa bed
Convenient vanity with pressure water, SS sink and mirror
Engine heat exchanger

Functional/Safety

Windows, lightly tinted, with screens
Automatic, electric bilge pump
Gravity bilge ventilation with electric bilge blower
Horn
Galvanic isolator
Fireboy Halon fire extinguisher system
Carbon monoxide monitoring system

Electrical

Two marine-quality batteries with cold-cranking amperage of 405 (reserve capacity 153 minutes)
Dockside wiring, 30 amp, 120 VAC with a 50 ft. shore cable
Cabin lighting, 12V
U.S. Coast Guard-approved navigation and anchor lights

Interior

Dinette/lounge converts to double berth
Private midship stateroom with double berth and 6'3" headroom
Forward V-berth
Color-coordinated carpeting, draperies and upholstery
Plush, stain- and soil-resistant 100% nylon carpeting
Fully lined 100% cotton drapes protected by Scotchguard

OPTIONAL EQUIPMENT

Helm Equipment

5" or 7" spotlight - electric remote control
Bennett electric/hydraulic trim tabs
Electric dual-trumpet horn
Compass
Engine hour meter(s)
Synchronizer for twin gas engines
Cigar lighter

Galley and Interior

Norcold dual-voltage refrigerator
Princess recessed alcohol/electric stove
Kenyon recessed propane stove
Cassette stereo with AM/FM radio
Air conditioning with reverse cycle heat
Decorator pillows

Weather Covers

Bimini top
Bimini top with full enclosure
Bridge cover

Heads

Electric head
Raritan crown electric head
15 gal. auxiliary holding tank
Overboard discharge for head (coastal markets only)

Electrical

Additional battery
Heavy-duty battery(s) (530 cold cranking amps)
20 amp battery charging system
Dual-dockside, 120V-30A
Voltmeter/ammeter kit
Dockside adaptor(s)

Exterior

Cockpit pressure seawater washdown
Heavy-duty gunwale molding
Exterior carpet

Propulsion

Engine fresh water cooling
Fuel tank selector valves

Safety and Miscellaneous

4 lb. portable fire extinguisher
Shipping cradle

For more information on the spacious, high-styled 27 Santeago, see your Carver dealer. We also invite you to visit our production facilities in Pulaski, WI. Call toll free 800/558-8190. (Wisconsin 800/242-4546; Canada 800/351-0644)

Information accurate at time of printing. Carver Boat Corporation reserves the right to change without notice: price, color, materials, equipment specifications or models. Models may also be discontinued without obligation to previous purchasers. All Carver yachts and cruisers carry a limited warranty. See your dealer for current specifications.

CARVER

Carver Boat Corporation
Industrial Drive
Pulaski, Wisconsin 54162-1010
414/822-3214

POWER BY

**VOLVO
PENTA**

CERTIFIED
NMMA