

630 **Santego**

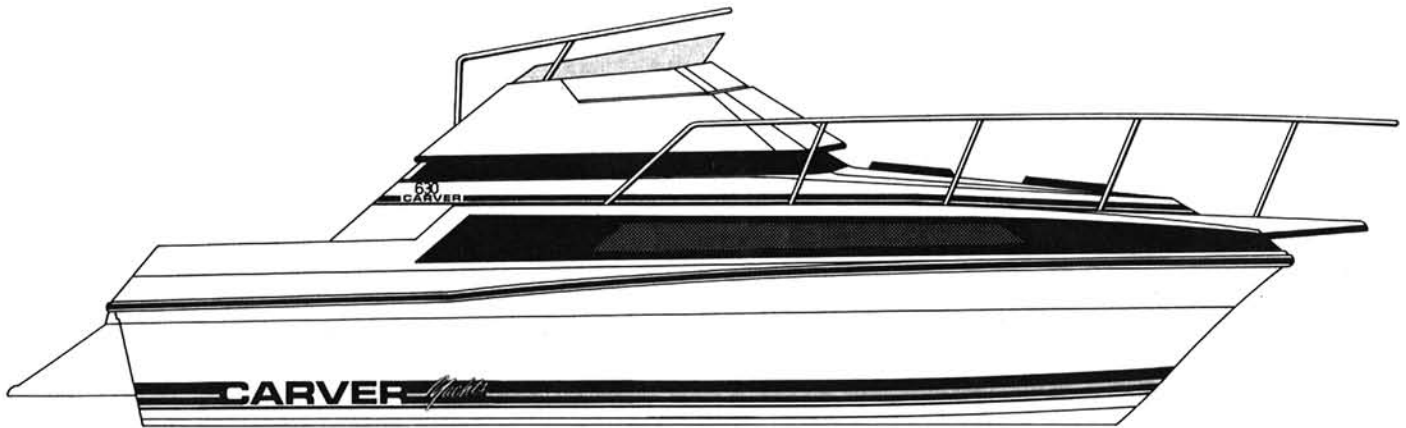

The Carver 630 Santego combines amazing liveability with sleek styling. There's sleeping room for six...a midship compartment with a double berth, a forward V-berth and a convertible dinette/lounge. The 630 is complete with galley and head

compartment with shower. Topside, there's a comfortable bridge arrangement, full lounge in the cockpit, built-in swim platform, bow pulpit and for those who really enjoy the sun, padded foredeck sun lounges!

SPECIFICATIONS

LOA w/platform	29'2"	8,90 m
LOA w/platform & pulpit	31'2"	9,50 m
Beam	10'0"	3,05 m
Draft	32"	0,81 m
Bridge Clearance	9'2"	2,79 m
With Optional Canvas	11'10"	3,61 m
Deadrise @ Transom	19 °	
Dry Weight (approx.)	8,400 lbs	3809,52 kg
Cabin Headroom	6'3"	1,92 m
Sleeping Capacity	6	
Fuel System	100 gal	378,53 L
Water System	41 gal	155,19 L
Waste System	15 gal	56,76 L

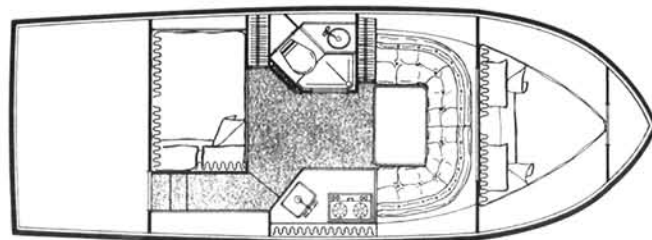
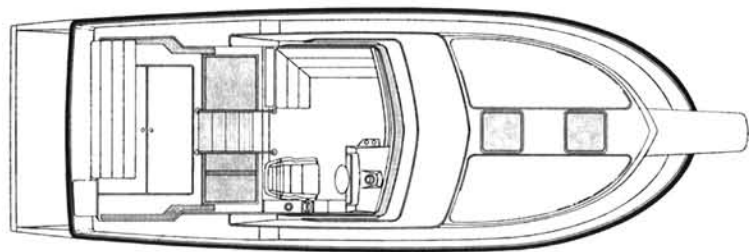

Carver 630 Santego

STANDARD EQUIPMENT

Helm Equipment

Engine synchronizer
Electric/hydraulic trim tabs
Cigar lighter
Compass
Engine hour meter(s)

Exterior

Welded SS bow and safety rails
SS deck hardware including 1 fore-deck mooring bit, 2-8" springline cleats and 2-8" stern cleats
Weather-sealed deck hatch with screen and hatch adjuster (2)
Navigation lights (USCG/NMMA approved)
Command bridge with helm, seating, wind deflector and storage
Teleflex console instrumentation includes fuel gauge, oil and temperature gauges, tachometers, voltmeter and dual-lever controls
Anti-skid fiberglass decks
Fiberglass swim platform with ladder
Bow pulpit
Sun lounge (2)

Galley and Head

Pressurized hot/cold water system
35 gallon fresh water tank
6 gallon water heater
Engine heat exchanger
Single SS sink
Recessed 2-burner alcohol stove
Upright insulated ice chest
Mirrored vanity with SS sink, head compartment
Self-contained, dockside discharge marine head
15 gallon holding tank
Pressurized hot and cold shower

Functional/Safety

Windows, tinted with screens
Halon fire extinguisher system
Automatic, bilge pump (1)
Gravity bilge ventilation
Electric horn
Carbon monoxide monitoring system
Galvanic isolator
Bonding system

Electrical

12 Vdc battery (2)
Cabin lighting, 12 Vdc
Dockside wiring, 30A, 110 Vac with 50 ft. shore cable
Exterior courtesy lights
110 Vac receptacles located throughout

Interior

Dinette converts to U-shaped berth
Mid-ship stateroom with double berth
Color-coordinated carpeting, draperies and upholstery
Plush, stain and soil-resistant 100% nylon carpeting
Fully lined 100% cotton drapes protected by Scotchgard

OPTIONAL EQUIPMENT

Helm Equipment

7" electric remote spotlight
5" electric remote spotlight
Dual-trumpet electric horn

Galley, Interior & Head

Grey water holding tank
Dual-voltage refrigerator
Recessed alcohol/electric stove
Recessed propane stove
Stereo cassette w/AM-FM radio
Leads for stereo
Air conditioning with reverse cycle heat
Decorator pillow (3)
Crown electric head with macerator
Electric flush head
Overboard discharge system

Weather Covers

Bimini top
Bimini top with full enclosure
Bridge cover

Electrical

Dual dockside 30A, 110 Vac
Heavy-duty battery (2)
20A battery charging system
Voltmeter/ammeter kit
Dockside adaptor(s)

Exterior

Hand shower in cockpit
Cockpit pressure seawater washdown
Heavy-duty gunwale molding
Cockpit and bridge exterior carpet

Propulsion

Single Stern Drive - Gas
7.4L Bravo II MerCruiser
740 Volvo DP
Twin Stern Drive - Gas
4.3LX MerCruiser
251 Volvo DOHC
431 Volvo DP
Twin Stern Drive - Diesel
AD31 Volvo DP
FWC MerCruiser, Volvo
Fuel tank selector valves

Safety and Miscellaneous

Shipping/storage cradle
4 lb. fire extinguisher
Loading charge
Shrink wrap

For more information on the 630 Santego, see your Carver dealer. We also invite you to visit our production facilities in Pulaski, WI. Call toll free 800/558-8190. (Wisconsin 800/242-4546; Canada 800/351-0644).

Information accurate at time of printing. Carver Boat Corporation reserves the right to change without notice: price, color, materials, equipment specifications or models. Models may also be discontinued without obligation to previous purchasers. All Carver Yachts and Cruisers carry a limited warranty. See your dealer for current specifications.

CARVER

Carver Boat Corporation
Industrial Drive
Pulaski, Wisconsin 54162
414/822-3214

POWER BY



Copyright 1990 Carver Boat Corporation.