

# 28 Aft Cabin

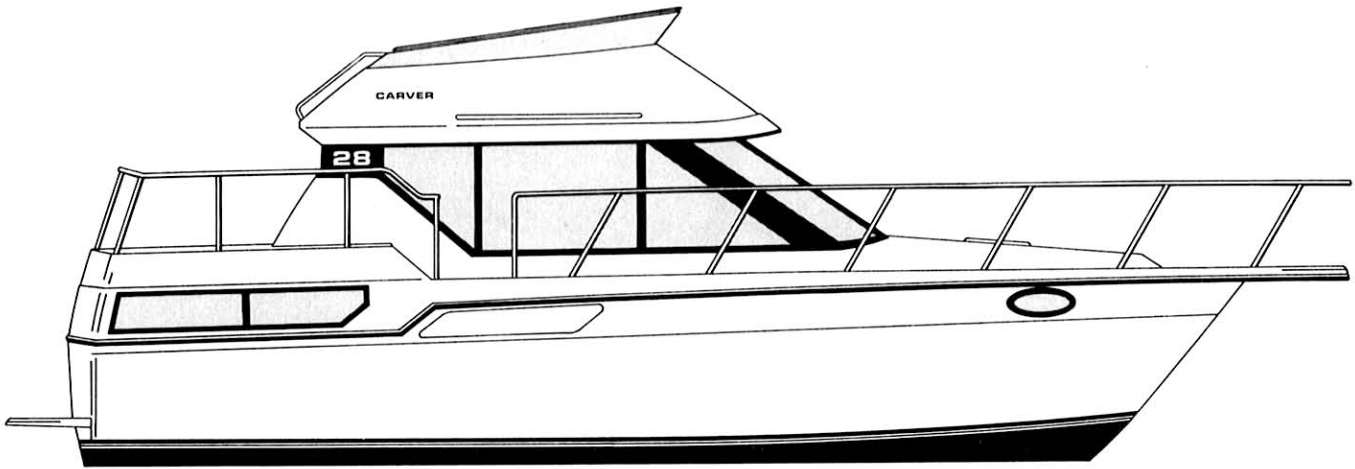

The all new Carver 28 Aft Cabin definitely follows suit with her sister ships, the 33, 36, 38 and 42 Aft Cabins. Her 11' 10" beam provides more amenities than you'd imagine on a 28 footer. The master stateroom aft has sleeping accommodations for three with both a double and single berth, and for your convenience, there's a vanity with sink. Her galley has a 2-burner electric/alcohol stove and a dual voltage

refrigerator/freezer, adjacent you'll find a comfortable dinette. And in the salon you'll find one of your most favorite features, large windows forward...What a view!

The 28 Aft Cabin, she's the newest member of the Carver Aft Cabin Family. If you haven't seen her in person, she's well worth a visit.

## SPECIFICATIONS

|                         |              |            |
|-------------------------|--------------|------------|
| LOA w/platform          | 30' 2"       | 9,20 m     |
| LOA w/platform & pulpit | 32' 9"       | 10,03 m    |
| Beam                    | 11' 10"      | 3,38 m     |
| Draft                   | 35"          | 0,89 m     |
| Bridge Clearance        | 11' 6"       | 3,54 m     |
| With Optional Canvas    | 14' 8"       | 4,51 m     |
| Deadrise @ Transom      | 16°          |            |
| Dry Weight (approx.)    | 11,700 lbs   | 5307,12 kg |
| Cabin Headroom          | 6' 2"        | 1,89 m     |
| Sleeping Capacity       | 6            |            |
| Fuel System             | 162 U.S. gal | 613,22 L   |
| Water System            | 51 U.S. gal  | 193,05 L   |
| Waste System            | 20 U.S. gal  | 75,71 L    |

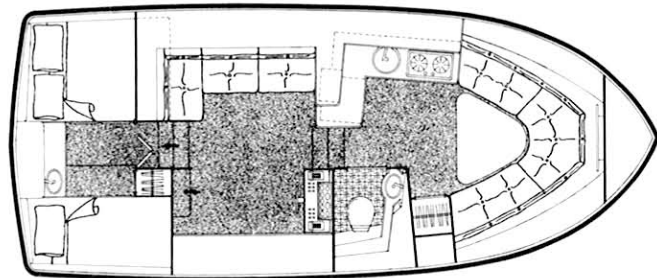

# Carver 28 Aft Cabin

## STANDARD EQUIPMENT

### Helm Equipment

Engine synchronizer  
Electric/hydraulic trim tabs  
Cigar lighter  
Compass  
Engine hour meters  
Teleflex console instrumentation includes back-lighted fuel gauge, oil and temperature gauges, tachometers and voltmeter

### Exterior

Welded SS bow and safety rails  
Bottom paint, anti-fouling  
SS deck hardware including 2-10" bow cleats, 2-8" springline cleats, 2-10" stern cleats and 1-10" anchor cleat  
Weather-sealed deck hatch with screen and hatch adjuster  
Navigation lights (USCG/NMMA approved)  
Command bridge with helm, seating, venturi windshield and storage  
Non-skid fiberglass decks  
Heavy-duty gunwale molding  
Fiberglass bow pulpit

### Galley and Head

Pressurized hot/cold water system  
40 gallon fresh water tank  
11 gallon water heater  
2-burner electric/alcohol stove  
Single SS galley sink  
Dual-voltage refrigerator/freezer  
Mirrored vanity with SS sink  
Self-contained, dockside discharge marine head  
20 gallon holding tank

### Functional/Safety

Windows, tinted with screens  
Halon fire extinguisher system  
Automatic, bilge pump (3)  
Gravity bilge ventilation  
Dual recessed electric horn  
Carbon monoxide monitoring system  
Galvanic isolator  
Bonding system  
Fuel selector valves

### Electrical

12 Vdc, 100A battery (2)  
Cabin lighting, 12 Vdc  
Dockside wiring, 110 Vac, 30A with 50 ft. shore cable  
12 Vdc wiring with hydraulic magnetic breakers  
Exterior courtesy lights  
110 Vac receptacles located throughout

### Interior

V-shaped dinette converts to berth  
Color-coordinated carpeting, draperies and upholstery  
Plush, stain and soil-resistant 100% nylon carpeting  
Fully lined 100% cotton drapes protected by Scotchguard  
Convertible sofa

## OPTIONAL EQUIPMENT

### Helm Equipment

Lower helm station & controls with pilot seat  
Electric remote spotlight

### Galley, Interior & Head

Grey water holding tank  
Microwave  
Blender  
Propane stove  
Shore water connection  
Stereo cassette w/AM-FM radio  
Air conditioning with reverse heat cycle  
Engine heat exchanger  
Water tank monitor  
Decorator pillow (6)  
Salon chair  
Crown electric head with macerator  
Overboard discharge system

### Electrical

3.0 kW gasoline generator  
Dual dockside 110 Vac, 30A  
20A battery charging system  
Dockside adaptor(s)

### Exterior

Full canvas with exterior carpet  
Pressure seawater washdown  
Windlass with remote drop & lift  
Fiberglass swim platform with ladder  
External sea water strainers  
Internal sea water strainers  
Fender rack (4)  
Bridge cover

### Propulsion

Twin Inboard - Gas  
5.7L MerCruiser  
305 CID Crusader  
350 CID Crusader  
501 Volvo  
570 Volvo  
Twin Inboard - Diesel  
TAMD31 Volvo  
FWC MerCruiser, Crusader, Volvo  
Spare props and shaft

### Safety and Miscellaneous

4 lb. fire extinguisher  
Loading charge  
Shrink wrap  
Storage cradle

For more information on the 28 Aft Cabin, see your Carver dealer. We also invite you to visit our production facilities in Pulaski, WI. Call toll free 800/558-8190. (Wisconsin 800/242-4546; Canada 800/351-0644).

Information accurate at time of printing. Carver Boat Corporation reserves the right to change without notice: price, color, materials, equipment specifications or models. Models may also be discontinued without obligation to previous purchasers. All Carver Yachts and Cruisers carry a limited warranty. See your dealer for current specifications.

## CARVER

Carver Boat Corporation  
Industrial Drive  
Pulaski, Wisconsin 54162  
414/822-3214

POWER BY

**VOLVO  
PENTA®**

CERTIFIED  
**NMMA®**