

44 MOTOR YACHT

COCKPIT

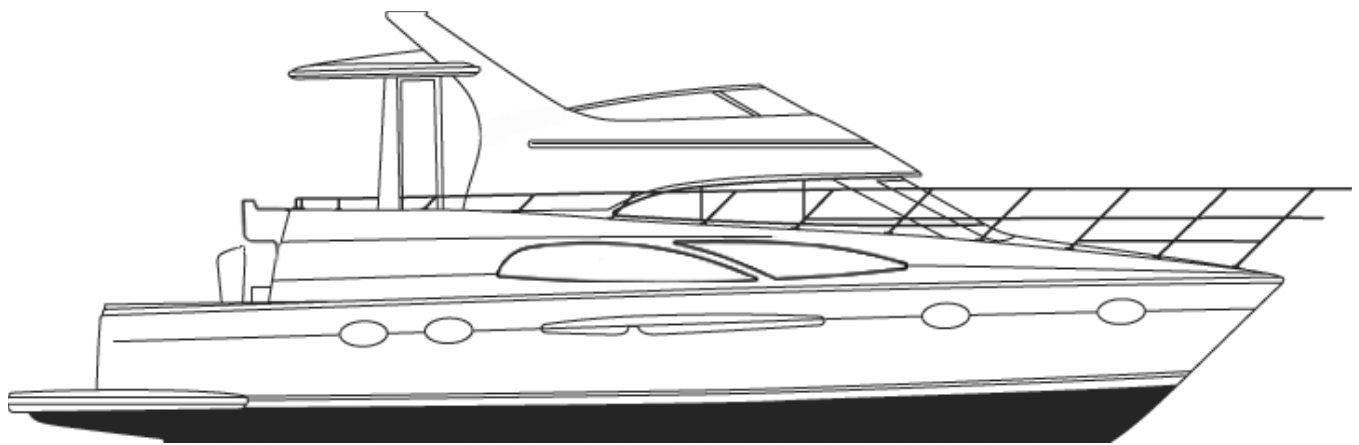

44 COCKPIT MOTOR YACHT

SPECIFICATIONS

LOA (w/platform)	46'6"	14,17 m
Beam	13'11"	4,24 m
Draft	42"	1,07 m
Bridge Clearance w/arch	18'0"	5,49 m
Weight (w/fuel & water)	33,860 lbs.	15358,90 kg
Water System	90 U.S. gals.	340,69 liters
Waste System	72 U.S. gals.	272,55 liters
Fuel System	404 gals.	1529,30 liters
Twin inboards (diesel)		
Cabin Headroom	6'10"	2,08 m
Sleeps	4 (6 optional)	

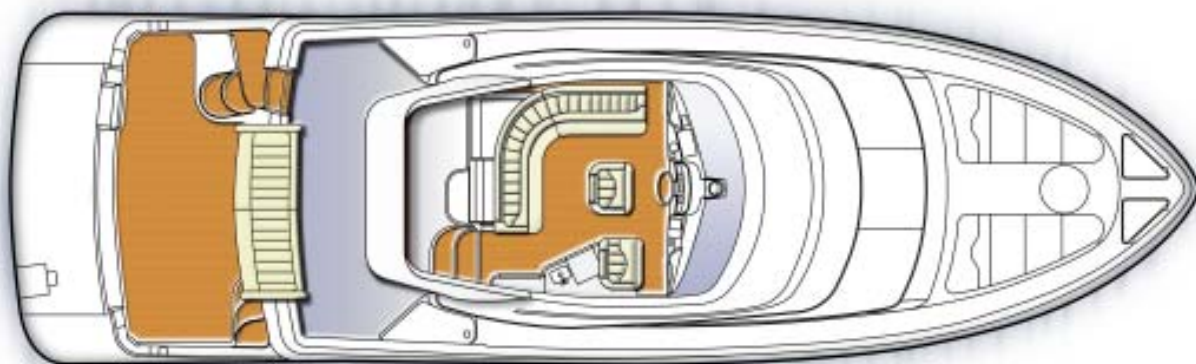

44 COCKPIT MOTOR YACHT

STANDARD FEATURES

CONSTRUCTION

- Structural engine mountings - reinforced stringer mountings with gusseted, angle steel plates
- Fabricated aluminum floor frames with stainless steel stanchions
- Hand-laid, molded fiberglass components featuring composite laminate hullsides, decks, and cabintops
- Molded fiberglass stringer system
- Cherry wood bulkheads, cabinetry, and trim throughout cabin, with high-gloss finish
- Solid fiberglass hull bottoms with Knytex substrates and Vinylester barrier coat
- Tinted, tempered safety glass frameless window systems
- Unitized deck, cockpit, and cabintop construction with integral aluminum truss reinforcement in cabintop structure

MECHANICAL

- Air conditioning - 3-zone, 35,000 BTU; with reverse cycle heat; dedicated shore power connector
- Cutlass bearings - synthetic rubber composite
- Dripless shaft logs
- Exhaust mufflers - engines, generator
- Fresh water cooling - engines
- Fuel tanks - welded, baffled 5052 aluminum
- Hydraulic steering
- Propellers - manufacturer-certified
- Propeller shafts - aquamet
- Rudders - 421 manganese bronze
- Seawater strainers
- Struts - 421 manganese bronze
- Trim tabs - stainless steel, hydraulic

ELECTRICAL

- AC/DC distribution panels with magnetic circuit breakers and integral generator and bilge blower controls; AC and DC voltmeters; AC and DC ammeters

- Batteries (5) - deep cycle, marine (12V)
- Battery chargers (2) - electronic, AC-DC converters
- External connectors - CATV, telephone
- Generator - 10.0 kW
- Ground Fault Circuit Interrupt (GFCI) protection - all 110V outlets
- Shore power connectors (2) - 50 amp
- Shore power cords (2) - 50 ft.
- Wiring system - tinned copper strand wire, harnessed, color-coded, labeled, meets or exceeds ABYC standards

WATER & WASTE SYSTEMS

- Fresh water system - pressurized (12V), with large-capacity filter
- Fresh water storage tanks (2) - polyethylene
- Fresh water tanks level monitor
- Shore water connection with pressure-reduction valve
- Shower sump pumps (2) - automatic/manual operation
- Waste holding tanks (2) - with filtered vents and dockside pumpouts
- Waste tank level monitors (2)
- Water and waste lines - constructed of molecularly cross-linked polyethylene
- Water heater - 11 gallons (110V)

SAFETY & NAVIGATION

- Anodes - zinc, sacrificial
- Battery master disconnect switches
- Battery restraint brackets
- Bilge alarm - high water
- Bilge blowers (12V)
- Bilge pumps (3) - 1500 gph each, automatic/manual operation
- Brass valves for all underwater thru-hulls
- CO detectors in salon and state-rooms
- Compass - illuminated, dual-read

- Engine alarms - temperature and oil pressure
- Fire suppression system - automatic, FE241 (FM200 in European Community)
- Galvanic isolator/zinc saver
- Horn - air/electric (12V), trumpet
- Internal bonding system
- Isolation transformers on the internal shore power lines
- Molded nonskid surfaces on all walk decks - diamond pattern
- Navigation lights (COLREGS)
- Spotlight
- Windlass package - with 35 lb. anchor and 200 ft. of 5/16" chain

BRIDGE

Command Bridge

- 110V outlet - GFCI protected
- Beverage holder - fold-out
- Lights (2) - courtesy, recessed, with exterior-mounted switch
- Lounge - L-shaped, with storage beneath, accommodates 5 adults
- Self-draining walk surface
- Storage locker
- Wet bar - self-draining with sink, preparation surface, bottle storage beneath

Helm

- Access panel - provides access to wiring below helm
- Accessory space - for installing navigation equipment
- Adapter - 12V
- Beverage holder - fold-out
- Companion seat - high-quality marine-grade upholstery, embroidery stitching
- Dash - fiberglass with faux burled walnut accents
- DC distribution panel - bridge 12V systems
- Grab rails (2) - stainless steel, on either end of helm
- Helm seat - pedestal, adjustable, high-quality marine-grade upholstery, embroidery stitching
- Stereo speakers (2) - pre-wired

44 COCKPIT MOTOR YACHT

- Tilt steering wheel
- Windshield - wraparound, aluminum frame

Instrumentation

- Gauges - synchronizer; rudder angle; tachometer with hourmeter (1 per engine); oil pressure, engine temperature, engine battery voltage, fuel level (multi-gauge, 1 per engine)
- Rocker switch controls

DECK

Aft Deck

- 73 ft² (approx.), integral to deck, self-draining
- Command bridge stairway - integral to deck with stainless steel hand rail
- Electronics arch - custom aluminum with acrylic polyurethane surface coating and UV protection
- Electronics arch access plates (5) - corrosion-resistant polymer attached with noncorroding screws and waterproof sealant
- Grab rail - stainless steel, across storage lockers
- Hand rail - 1.0" OD, stainless steel, around entire aft deck
- Hardtop over entire aft deck
- Lights (4) - courtesy, recessed, with exterior-mounted switch
- Lights (2) - halogen, overhead, recessed, with exterior-mounted switch
- Lounge - with storage beneath, accommodates 4 adults
- Stereo speakers (2) - pre-wired
- Storage lockers (2) - upper and lower, double doors, interior stainless steel restraining rail
- Transom door - aluminum, secures closed, stainless steel hardware, with stainless steel grab rail across top
- Wing doors (2) - clear acrylic in aluminum frame, secure open and closed, provide access to side decks

Side Decks

- Bow rail - 1.0" O.D., lineal-buffed, welded stainless steel, with additional intermediate rail amidships and forward
- Bow rail stanchions - double-welded (inside and outside), stainless steel, anchored to aluminum backing plates laminated into deck
- Cleats (4) - 10" spring, stainless steel, bolted through aluminum backing plate
- Deck toe rail
- Grab rail - stainless steel, over cabin windows, running length of cabin and above windshields
- Boarding doors (2) - aluminum, port and starboard, double latch, stainless steel hardware
- Rub rail molding - heavy-duty, stainless steel insert

Fore Deck

- Cleats (2) - 10" stainless steel, bolted through aluminum backing plate
- Cleat - 10" stainless steel, for anchor line, bolted through aluminum backing plate
- Locker - in-deck, self-draining, for fender storage and anchor chain
- Over-the-stem anchor roller

COCKPIT

- 60 ft² (approx.), integral to hull and deck, self-draining
- Aft deck stairway - integral to deck, with 2 stainless steel hand rails
- Boarding access from port or starboard dock, with stainless steel hand rails
- Cleats (2) - 10" stainless steel, bolted through aluminum backing plate, inboard-mounted with stainless steel hawse pipes
- Direct access to master stateroom
- Hatch - guttered, watertight, provides access to aft bilge
- Lights (4) - courtesy, recessed, with exterior-mounted switch

- Storage locker - transom, 2 doors, restraining bolster inside
- Transom door - aluminum, secures closed, stainless steel hardware, with stainless steel grab rail across top

ENGINE ROOM

- Bilges coated with white, low-VOC gelcoat
- Bulkheads laminated to hull sides and stringers
- Diamond plate aluminum catwalk
- Insulation - acoustical and thermal, vinyl vapor barrier
- Lights (4) - halogen, overhead, control mounted under bottom salon stairway step

BOARDING PLATFORM

- 26 ft² (approx.), integral to hull and deck
- Boarding ladder - telescoping, with grab rail, conceals in boarding platform
- Cleats (2) - 10" stainless steel, bolted through aluminum backing plate
- Hand rail - 1.0" OD, stainless steel, across entire transom

SALON

- 110V outlets (3) - GFCI protected
- AC and DC distribution panels
- Cabin stairway - integral, with cherry wood hand rail
- Carpet - tufted cut pile, 65 oz., crush-resistant, 100% nylon
- Countertops - sapele pommele inlay with cherry wood trim
- Curtains - décor-matched
- Décor package - 10-piece decorator pillow set
- Designer décor
- Entertainment group - 20" LCD TV and DVD, AM/FM/CD stereo, satellite radio system, 2 speakers each in salon, master stateroom
- Entrance door - translucent acrylic, curved, sliding, handle lock, with interior screen
- Floor access hatches - engine room

44 COCKPIT MOTOR YACHT

- Fresh air system - passive, with controllable overhead vents
- Lights (9) - halogen, overhead, recessed
- Lounge - Flexsteel, with double incliners, 36" end, corner extension with storage beneath
- Miniblinds - décor-matched
- Rocker light switches
- Sofa - Flexsteel, with storage beneath
- Stereo speakers (2)
- Storage cabinets (5)
- Table - hi-lo, sapele pommele inlay top with raised cherry wood trim; cherry wood base including lower shelf
- Telephone connector

GALLEY

- 110V outlet - GFCI protected
- Coffeemaker
- Countertops - solid surface
- Designer décor
- Flooring - wood plank
- Lights (2) - halogen, overhead, recessed
- Oven - convection / microwave, built-in
- Range - electric, 3-burner, smooth top
- Refrigerator/freezer - upright
- Rocker light switches
- Sink - with solid surface cover
- Storage cabinets (2)
- Storage drawers (4)

MASTER STATEROOM

- 110V outlets (3) - GFCI protected
- Berth - queen, inner-spring mattress, offset island
- Berth endtables (2) - sapele pommele inlay with cherry wood trim
- Carpet - tufted cut pile, 65 oz., crush-resistant, 100% nylon
- Cockpit door - tinted glass in aluminum frame, sliding, locking latch, inside deadbolt with flush-mounted handle, interior screen
- Countertops - sapele pommele inlay with cherry wood trim
- Curtains - décor-matched

- DC distribution panel - 12V safety systems
- Designer décor
- Entrance door - 2-panel, solid cherry wood frame with sapele pommele panels exterior, cherry wood panels interior, secures open and closed, stainless steel hardware
- Hanging lockers (2) - cedar-lined, automatic light
- Lights (2) - halogen, reading, recessed
- Lights (3) - halogen, overhead, recessed
- Miniblinds - décor-matched
- Portlights (2) - with screen
- Rocker light switches
- Sheet set - embroidered, fitted sheet, flat sheet, two pillow cases
- Stereo speakers (2) - with volume control
- Storage cabinets (4)
- Storage drawers (3)
- Telephone connector

MASTER HEAD

- 110V outlet - GFCI protected
- Entrance door - 2-panel cherry wood, secures closed, integral doorstop, stainless steel hardware
- Hardware highlights - brass/chrome
- Head fan
- Lights (2) - halogen, overhead, recessed
- Medicine cabinet - sliding mirrored doors, 2 shelves
- Nonskid sole
- Portlights (2) - privacy glass, with screen
- Rocker light switches
- Soap dish - solid glass, wall-mounted
- Toilet - vacuum flush, pedestal
- Toilet paper holder - mounted in vanity
- Towel ring
- Towel set - bath towel, hand towel, washcloth
- Vanity - solid surface top and backsplash, undermounted sink, drawer beneath, cabinet beneath with door

Shower Stall

- Bench seat - integral
- Entrance door - clear acrylic in aluminum frame, secures closed
- Light - halogen, overhead, recessed
- Nonskid sole
- Shower head - detachable for use as handshower
- Towel bar

GUEST STATEROOM

- 110V outlets (2) - GFCI protected
- Berth - queen, island
- Berth step-ups (2) - carpeted
- Carpet - tufted cut pile, 65 oz., crush-resistant, 100% nylon
- Curtains - décor-matched
- Designer décor
- Entrance door - 2-panel, solid cherry wood frame with sapele pommele panels exterior, cherry wood panels interior, pocket-style, secures open and closed, stainless steel hardware
- Hanging locker - cedar-lined, automatic light, integral doorstop
- Ledge tops - cherry wood
- Lights (5) - halogen, overhead, recessed
- Mirrored headboard
- Overhead hatch - translucent, lockable, inside screen
- Portlights (2) - with screen
- Rocker light switches
- Sheet set - embroidered, fitted sheet, flat sheet, two pillow cases
- Storage cabinets (4)
- Telephone connector

GUEST HEAD

- 110V outlet - GFCI protected
- Entrance door - 2-panel cherry wood, secures closed, integral doorstop, stainless steel hardware
- Hardware highlights - brass/chrome
- Head fan
- Lights (2) - halogen, overhead, recessed
- Medicine cabinets (3) - mirrored doors, 2 shelves
- Nonskid sole

44 COCKPIT MOTOR YACHT

- Portlight - privacy glass, with screen
- Rocker light switch
- Soap dish - solid glass, wall-mounted
- Toilet - vacuum flush, pedestal
- Toilet paper holder
- Towel ring
- Towel set - bath towel, hand towel, washcloth
- Vanity - solid surface top and backsplash, undermounted sink, drawer beneath, 2 shelves beneath with door

Shower Stall

- Bench seat - integral
- Entrance door - 2-panel cherry wood, secures closed, stainless steel hardware, integral doorstop
- Grab rail - stainless steel
- Hardware highlights - brass/chrome
- Light - halogen, overhead, recessed
- Nonskid sole
- Portlight - privacy glass, with screen
- Shower accessories cabinet - mirrored doors
- Shower curtain - décor-matched, with matching tie-back
- Shower head - detachable for use as handshower

44 COCKPIT MOTOR YACHT

OWNER PREFERENCE ITEMS

PROPULSION

Diesel Engines

- Volvo TAMD 63P
- Volvo D6 - 370 hp
- Yanmar - 440 hp

MECHANICAL

- Bow thruster
- Engine oil change system
- Single station electronic controls with synchronization

ELECTRICAL

- Cablemaster for shore power
- Generator - Onan 11.5 kW

WATER & WASTE SYSTEMS

- Grey water holding system
- Hot and cold transom handshower
- Overboard discharge system

Transom and Bow Washdowns

- Both fresh and seawater
- Fresh water
- Seawater

SAFETY & NAVIGATION

- Fender racks (not available with lower helm)
- Lower helm with electronic controls and synchronization, windshield wipers, third stateroom
- Spare propellers and shaft

Electronics Package

- Without lower helm
- With lower helm

EXTERIOR AMENITIES

- Bridge cover
- Carpet
- Foredeck sunpad
- Icemaker (in lieu of wet bar storage)
- Stereo - AM/FM receiver with CD changer, antenna, speakers
- Transom storage locker

Canvas

- "Prestige" bimini top
- "Prestige" full canvas with carpet

Canvas Color

- Black Sunbrella
- White Sunbrella
- Captain's navy
- Toast

DÉCOR

Ensemble

- Biscayne (blue tones)
- Catalina (neutral tones)

Coordinated Countertops

- Black magic (black)
- Harvest moon (tan)
- Savannah (neutral)

Interior Seating Material/Color

- Ultraleather buff
- Ultraleather pecan

Carpet

- Cashmere beige
- Deep cream

CABIN AMENITIES - SALON

- 44 extended salon (ES) version
- Additional dining chair
- Central vacuum system
- Pillow set - decorator, 6-piece
- Stereo addition - remote-mounted 6-disc CD player

Port Side Furniture

- Sofa with stowaway bed
- Dining table with 3 dining chairs (in lieu of hi-lo table)

CABIN AMENITIES - GALLEY

- Dinette with triangular table (in lieu of lounge corner extension and hi-lo table)
- Pantry (not available with lower helm or dinette)

CABIN AMENITIES - FORWARD & AFT

- TV and DVD - 15" LCD, in master stateroom
- TV and DVD - 15" LCD, in guest stateroom
- Upper bunk in guest stateroom
- Washer/dryer combo unit

MISCELLANEOUS

- Loading charge
- Shipping cradle
- Shrink wrap



Carver Boat Corporation LLC • P. O. Box 1010 • Pulaski, WI 54162-1010 • 920-822-3214
www.carveryachts.com

Carver Boat Corporation reserves the right to change price, colors, materials, equipment specifications or models without notice. Models may be discontinued without obligation to previous purchasers. Illustrations may include optional equipment. Some electrical equipment is only offered in 120V/60Hz; check with your Carver Dealer for availability outside the U.S.

01/01/05

44 MOTOR YACHT

EXTENDED SALON

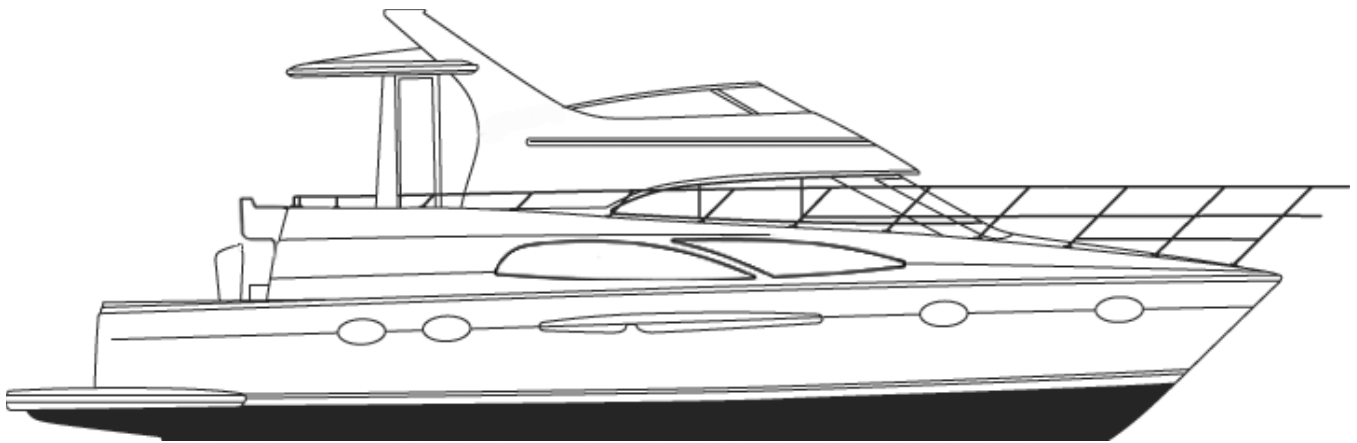



CARVER[®]
YACHTS

44ES COCKPIT MOTOR YACHT

SPECIFICATIONS

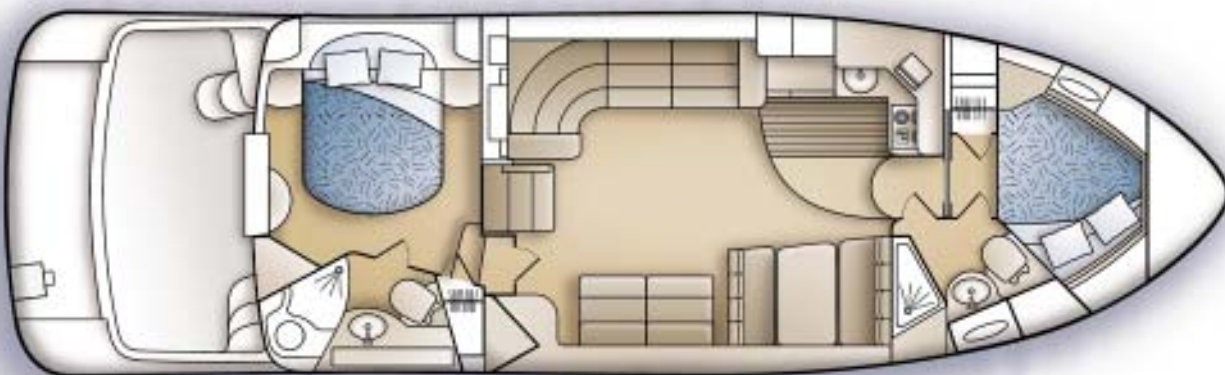
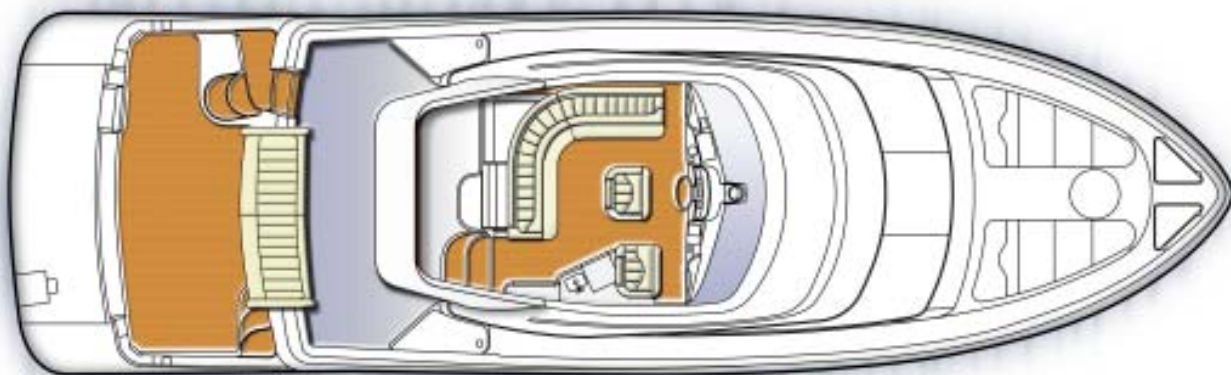
LOA (w/platform)	46'6"	14,17 m
Beam	13'11"	4,24 m
Draft	42"	1,07 m
Bridge Clearance w/arch	18'0"	5,49 m
Weight (w/fuel & water)	34,260 lbs.	15540,34 kg
Water System	90 U.S. gals.	340,69 liters
Waste System	72 U.S. gals.	272,55 liters
Fuel System	404 gals.	1529,30 liters
Twin inboards (diesel)		
Cabin Headroom	6'10"	2,08 m
Sleeps	4 (6 optional)	



44ES COCKPIT MOTOR YACHT

STANDARD FEATURES

CONSTRUCTION

- Structural engine mountings - reinforced stringer mountings with gusseted, angle steel plates
- Fabricated aluminum floor frames with stainless steel stanchions
- Hand-laid, molded fiberglass components featuring composite laminate hullsides, decks, and cabintops
- Molded fiberglass stringer system
- Cherry wood bulkheads, cabinetry, and trim throughout cabin, with high-gloss finish
- Solid fiberglass hull bottoms with Knytex substrates and Vinylester barrier coat
- Tinted, tempered safety glass frameless window systems
- Unitized deck, cockpit, and cabintop construction with integral aluminum truss reinforcement in cabintop structure

MECHANICAL

- Air conditioning - 3-zone, 35,000 BTU; with reverse cycle heat; dedicated shore power connector
- Cutlass bearings - synthetic rubber composite
- Dripless shaft logs
- Exhaust mufflers - engines, generator
- Fresh water cooling - engines
- Fuel tanks - welded, baffled 5052 aluminum
- Hydraulic steering
- Propellers - manufacturer-certified
- Propeller shafts - aquamet
- Rudders - 421 manganese bronze
- Seawater strainers
- Struts - 421 manganese bronze
- Trim tabs - stainless steel, hydraulic

ELECTRICAL

- AC/DC distribution panels with magnetic circuit breakers and integral generator and bilge blower controls; AC and DC voltmeters; AC and DC ammeters

- Batteries (5) - deep cycle, marine (12V)
- Battery chargers (2) - electronic, AC-DC converters
- External connectors - CATV, telephone
- Generator - 10.0 kW
- Ground Fault Circuit Interrupt (GFCI) protection - all 110V outlets
- Shore power connectors (2) - 50 amp
- Shore power cords (2) - 50 ft.
- Wiring system - tinned copper strand wire, harnessed, color-coded, labeled, meets or exceeds ABYC standards

WATER & WASTE SYSTEMS

- Fresh water system - pressurized (12V), with large-capacity filter
- Fresh water storage tanks (2) - polyethylene
- Fresh water tanks level monitor
- Shore water connection with pressure-reduction valve
- Shower sump pumps (2) - automatic/manual operation
- Waste holding tanks (2) - with filtered vents and dockside pumpouts
- Waste tank level monitors (2)
- Water and waste lines - constructed of molecularly cross-linked polyethylene
- Water heater - 11 gallons (110V)

SAFETY & NAVIGATION

- Anodes - zinc, sacrificial
- Battery master disconnect switches
- Battery restraint brackets
- Bilge alarm - high water
- Bilge blowers (12V)
- Bilge pumps (3) - 1500 gph each, automatic/manual operation
- Brass valves for all underwater thru-hulls
- CO detectors in salon and state-rooms
- Compass - illuminated, dual-read

- Engine alarms - temperature and oil pressure
- Fire suppression system - automatic, FE241 (FM200 in European Community)
- Galvanic isolator/zinc saver
- Horn - air/electric (12V), trumpet
- Internal bonding system
- Isolation transformers on the internal shore power lines
- Molded nonskid surfaces on all walk decks - diamond pattern
- Navigation lights (COLREGS)
- Spotlight
- Windlass package - with 35 lb. anchor and 200 ft. of 5/16" chain

BRIDGE

Command Bridge

- 110V outlet - GFCI protected
- Beverage holder - fold-out
- Lights (2) - courtesy, recessed, with exterior-mounted switch
- Lounge - L-shaped, with storage beneath, accommodates 5 adults
- Self-draining walk surface
- Storage locker
- Wet bar - self-draining with sink, preparation surface, bottle storage beneath

Helm

- Access panel - provides access to wiring below helm
- Accessory space - for installing navigation equipment
- Adapter - 12V
- Beverage holder - fold-out
- Companion seat - high-quality marine-grade upholstery, embroidery stitching
- Dash - fiberglass with faux burled walnut accents
- DC distribution panel - bridge 12V systems
- Grab rails (2) - stainless steel, on either end of helm
- Helm seat - pedestal, adjustable, high-quality marine-grade upholstery, embroidery stitching
- Stereo speakers (2) - pre-wired

44ES COCKPIT MOTOR YACHT

- Tilt steering wheel
- Windshield - wraparound, aluminum frame

Instrumentation

- Gauges - synchronizer; rudder angle; tachometer with hourmeter (1 per engine); oil pressure, engine temperature, engine battery voltage, fuel level (multi-gauge, 1 per engine)
- Rocker switch controls

DECK

Aft Deck

- 73 ft² (approx.), integral to deck, self-draining
- Command bridge stairway - integral to deck with stainless steel hand rail
- Electronics arch - custom aluminum with acrylic polyurethane surface coating and UV protection
- Electronics arch access plates (5) - corrosion-resistant polymer attached with noncorroding screws and waterproof sealant
- Grab rail - stainless steel, across storage lockers
- Hand rail - 1.0" OD, stainless steel, around entire aft deck
- Hardtop over entire aft deck
- Lights (4) - courtesy, recessed, with exterior-mounted switch
- Lights (2) - halogen, overhead, recessed, with exterior-mounted switch
- Lounge - with storage beneath, accommodates 4 adults
- Stereo speakers (2) - pre-wired
- Storage lockers (2) - upper and lower, double doors, interior stainless steel restraining rail
- Transom door - aluminum, secures closed, stainless steel hardware, with stainless steel grab rail across top
- Wing doors (2) - clear acrylic in aluminum frame, secure open and closed, provide access to side decks

Side Decks

- Bow rail - 1.0" O.D., lineal-buffed, welded stainless steel, with additional intermediate rail amidships and forward
- Bow rail stanchions - double-welded (inside and outside), stainless steel, anchored to aluminum backing plates laminated into deck
- Cleats (4) - 10" spring, stainless steel, bolted through aluminum backing plate
- Deck toe rail
- Grab rail - stainless steel, over cabin windows, running length of cabin and above windshields
- Boarding doors (2) - aluminum, port and starboard, double latch, stainless steel hardware
- Rub rail molding - heavy-duty, stainless steel insert

Fore Deck

- Cleats (2) - 10" stainless steel, bolted through aluminum backing plate
- Cleat - 10" stainless steel, for anchor line, bolted through aluminum backing plate
- Locker - in-deck, self-draining, for fender storage and anchor chain
- Over-the-stem anchor roller

COCKPIT

- 60 ft² (approx.), integral to hull and deck, self-draining
- Aft deck stairway - integral to deck, with 2 stainless steel hand rails
- Boarding access from port or starboard dock, with stainless steel hand rails
- Cleats (2) - 10" stainless steel, bolted through aluminum backing plate, inboard-mounted with stainless steel hawse pipes
- Direct access to master stateroom
- Hatch - guttered, watertight, provides access to aft bilge
- Lights (4) - courtesy, recessed, with exterior-mounted switch

- Storage locker - transom, 2 doors, restraining bolster inside
- Transom door - aluminum, secures closed, stainless steel hardware, with stainless steel grab rail across top

ENGINE ROOM

- Bilges coated with white, low-VOC gelcoat
- Bulkheads laminated to hull sides and stringers
- Diamond plate aluminum catwalk
- Insulation - acoustical and thermal, vinyl vapor barrier
- Lights (4) - halogen, overhead, control mounted under bottom salon stairway step

BOARDING PLATFORM

- 26 ft² (approx.), integral to hull and deck
- Boarding ladder - telescoping, with grab rail, conceals in boarding platform
- Cleats (2) - 10" stainless steel, bolted through aluminum backing plate
- Hand rail - 1.0" OD, stainless steel, across entire transom

SALON

- 110V outlet - GFCI protected
- AC and DC distribution panels
- Cabin stairway - integral, with cherry wood hand rail
- Carpet - tufted cut pile, 65 oz., crush-resistant, 100% nylon
- Countertops - sapele pommele inlay with cherry wood trim
- Curtains - décor-matched
- Décor package - 10-piece decorator pillow set
- Designer décor
- Entertainment group - 20" LCD TV and DVD, AM/FM/CD stereo, satellite radio system, 2 speakers each in salon, master stateroom
- Entrance door - translucent acrylic, curved, sliding, handle lock, with interior screen
- Floor access hatches - engine room

44ES COCKPIT MOTOR YACHT

- Fresh air system - passive, with controllable overhead vents
- Lights (10) - halogen, overhead, recessed
- Lounge - Flexsteel, with double incliners, corner extension with storage beneath
- Rocker light switches
- Sofa - Flexsteel, with storage beneath
- Stereo speakers (2)
- Storage cabinets (3)
- Telephone connector

GALLEY

- 110V outlet - GFCI protected
- Coffeemaker
- Countertops - work area is solid surface, other is sapele pommele inlay with cherry wood trim
- Designer décor
- Flooring - wood plank
- Hardware highlights - brass/ chrome
- Lights (2) - halogen, overhead, recessed
- Lights (2) - fluorescent, over work area, recessed
- Oven - convection / microwave, built-in
- Range - electric, 3-burner, smooth top
- Refrigerator/freezer - side-by-side, under counter
- Rocker light switches
- Sink - stainless steel, under-mounted
- Storage - under sink with 2 rotating, slide-out, coated wire racks
- Storage cabinets (5)
- Storage drawers (3)

DINETTE

- Bench seats (2) - with cherry wood base
- Countertop - sapele pommele inlay with cherry wood trim
- Curtains - décor-matched
- Light - halogen, overhead, recessed
- Storage drawer

- Table - sapele pommele inlay top with cherry wood trim; 2 brushed aluminum, adjustable height legs

MASTER STATEROOM

- 110V outlets (3) - GFCI protected
- Berth - queen, inner-spring mattress, offset island
- Berth endtables (2) - sapele pommele inlay with cherry wood trim
- Carpet - tufted cut pile, 65 oz., crush-resistant, 100% nylon
- Cockpit door - tinted glass in aluminum frame, sliding, locking latch, inside deadbolt with flush-mounted handle, interior screen
- Countertops - sapele pommele inlay with cherry wood trim
- Curtains - décor-matched
- DC distribution panel - 12V safety systems
- Designer décor
- Entrance door - 2-panel, solid cherry wood frame with sapele pommele panels exterior, cherry wood panels interior, secures open and closed, stainless steel hardware
- Hanging lockers (2) - cedar-lined, automatic light
- Lights (2) - halogen, reading, recessed
- Lights (3) - halogen, overhead, recessed
- Miniblinds - décor-matched
- Portlights (2) - with screen
- Rocker light switches
- Sheet set - embroidered, fitted sheet, flat sheet, two pillow cases
- Stereo speakers (2) - with volume control
- Storage cabinets (4)
- Storage drawers (3)
- Telephone connector

MASTER HEAD

- 110V outlet - GFCI protected
- Entrance door - 2-panel cherry wood, secures closed, integral doorstop, stainless steel hardware
- Hardware highlights - brass/ chrome

- Head fan
- Lights (2) - halogen, overhead, recessed
- Medicine cabinet - sliding mirrored doors, 2 shelves
- Nonskid sole
- Portlights (2) - privacy glass, with screen
- Rocker light switches
- Soap dish - solid glass, wall-mounted
- Toilet - vacuum flush, pedestal
- Toilet paper holder - mounted in vanity
- Towel ring
- Towel set - bath towel, hand towel, washcloth
- Vanity - solid surface top and backsplash, undermounted sink, drawer beneath, cabinet beneath with door

Shower Stall

- Bench seat - integral
- Entrance door - clear acrylic in aluminum frame, secures closed
- Light - halogen, overhead, recessed
- Nonskid sole
- Shower head - detachable for use as handshower
- Towel bar

GUEST STATEROOM

- 110V outlets (2) - GFCI protected
- Berth - double
- Berth step-up - carpeted
- Carpet - tufted cut pile, 65 oz., crush-resistant, 100% nylon
- Curtains - décor-matched
- Designer décor
- Entrance door - 2-panel, solid cherry wood frame with sapele pommele panels exterior, cherry wood panels interior, pocket-style, secures open and closed, stainless steel hardware
- Hanging locker - cedar-lined
- Ledge tops - cherry wood
- Light - halogen, overhead, recessed
- Lights (2) - halogen, overhead, directable for reading

44ES COCKPIT MOTOR YACHT

- Mirrored headboard
- Overhead hatch - translucent, lockable, inside screen
- Portlights (2) - with screen
- Private guest head access
- Rocker light switches
- Sheet set - embroidered, fitted sheet, flat sheet, two pillow cases
- Storage cabinets (2)
- Storage drawers (2)
- Telephone connector
- Nonskid sole
- Shower head - detachable for use as handshower
- Skylight

GUEST HEAD

- 110V outlet - GFCI protected
- Entrance doors (2) - one to guest stateroom (2-panel cherry wood) and one to companionway (2-panel, solid cherry wood frame with sapele pommele panels exterior, cherry wood panels interior), secure closed, integral doorstop stainless steel hardware
- Head fan
- Light - halogen, overhead, recessed
- Medicine cabinets (2) - mirrored doors, 2 shelves
- Nonskid sole
- Portlight - privacy glass, with screen
- Rocker light switch
- Soap dish - solid glass, wall-mounted
- Toilet - vacuum flush, pedestal
- Toilet paper holder - mounted in vanity
- Towel ring
- Towel set - bath towel, hand towel, washcloth
- Vanity - solid surface top and backsplash, undermounted stainless steel sink, cabinet beneath with door

Shower Stall

- Bench seat - integral
- Entrance door - clear acrylic in aluminum frame, bi-fold, secures closed
- Light - halogen, overhead, recessed
- Mirror

44ES COCKPIT MOTOR YACHT

OWNER PREFERENCE ITEMS

PROPULSION

Diesel Engines

- Volvo TAMD 63P
- Volvo D6 - 370 hp
- Yanmar - 440 hp

MECHANICAL

- Bow thruster
- Engine oil change system
- Single station electronic controls with synchronization

ELECTRICAL

- Cablemaster for shore power
- Generator - Onan 11.5 kW

WATER & WASTE SYSTEMS

- Grey water holding system
- Hot and cold transom handshower
- Overboard discharge system

Transom and Bow Washdowns

- Both fresh and seawater
- Fresh water
- Seawater

SAFETY & NAVIGATION

- Electronics package
- Fender racks
- Spare propellers and shaft

EXTERIOR AMENITIES

- Bridge cover
- Carpet
- Foredeck sunpad
- Icemaker (in lieu of wet bar storage)
- Stereo - AM/FM receiver with CD changer, antenna, speakers
- Transom storage locker

Canvas

- "Prestige" bimini top
- "Prestige" full canvas with carpet

Canvas Color

- Black Sunbrella
- White Sunbrella
- Captain's navy
- Toast

DÉCOR

Ensemble

- Biscayne (blue tones)
- Catalina (neutral tones)

Coordinated Countertops

- Black magic (black)
- Harvest moon (tan)
- Savannah (neutral)

Interior Seating Material/Color

- Ultraleather buff
- Ultraleather pecan

Carpet

- Cashmere beige
- Deep cream

CABIN AMENITIES - SALON

- Central vacuum system
- Pillow set - decorator, 6-piece
- Stereo addition - remote-mounted 6-disc CD player

Starboard Side Furniture

- Sofa with stowaway bed
- Sofa with incliner

CABIN AMENITIES - FORWARD & AFT

- TV and DVD - 15" LCD, in master stateroom
- TV and DVD - 15" LCD, in guest stateroom
- Washer/dryer combo unit

MISCELLANEOUS

- Loading charge
- Shipping cradle
- Shrink wrap



Carver Boat Corporation LLC • P. O. Box 1010 • Pulaski, WI 54162-1010 • 920-822-3214
www.carveryachts.com

Carver Boat Corporation reserves the right to change price, colors, materials, equipment specifications or models without notice. Models may be discontinued without obligation to previous purchasers. Illustrations may include optional equipment. Some electrical equipment is only offered in 120V/60Hz; check with your Carver Dealer for availability outside the U.S.

01/01/05